

2018 EVENT PROGRAM

# Whip Cancer 2018

ON  
*THE* OREGON TRAIL

JUNE 1 ★ 2 2018

HERGOTT FARM, HEBRON, NEBRASKA



WWW.CATTLEMENSBALL.COM



# We Give the "Thumbs Up" to Cancer Research



**President Donald J. Trump and Charles W. Herbster**  
Charles is the National Chairman of the Agricultural and Rural Advisory Committee for President Donald J. Trump and Owner and President of Herbster Angus Farms Inc., Conkin Company Inc., Judy's Dream Inc., Carico Farms Inc., and North American Breeders Inc.

**Herbster Angus Farms  
supports the 2018  
Nebraska Cattlemen's Ball**



# HERBSTER

## ANGUS FARMS

Charles W. Herbster (402) 801-1420  
Falls City, Nebraska [www.herbsterangus.com](http://www.herbsterangus.com)

# TABLE OF CONTENTS

4	Schedule of Events	}	<b>OVERVIEW</b>
5	Site Map		
6	General Information		
			<b>COLON CANCERS</b>
9	Host Families Welcome	}	<b>INTRODUCTIONS</b>
10	Co-Chairs Welcome		
11	Advisory Board Welcome		
12	Gov. Pete Ricketts Address		
13	Committee Chairmen		
17	Dr. Cowan Address		<b>KIDNEY*Liver CANCERS</b>
18	Trail Boss Friday Reception/Auction	}	<b>TRAIL BOSS EVENTS</b>
19	Trail Boss Saturday Champagne Breakfast		
20	Trail Boss Saturday Luncheon		
21	Main Event Evening Meal		
	Prime Rib Dinner & Auction		
			<b>BONE*CHILDHOOD CANCER</b>
22	Farm & Ranch Auction	}	<b>FARM * RANCH AUCTION</b>
			<b>OVARIAN*CERVICAL</b>
24	Silent Auction	}	<b>SILENT AUCTION</b>
			<b>BRAIN CANCER</b>
30	Tracy Lawrence with Lucas	}	<b>ENTERTAINMENT</b>
31	Trace Adkins with Forgotten Hwy		
32	Ranch Rodeo		
33	Style Show		
34	Golf Outing		
35	Rawhide Run		
36	Activities		
			<b>PROSTATE CANCER</b>
38	Truck Raffle	}	<b>RETAIL, RAFFLES * REFRESHMENT</b>
40	General Store		
41	Craft Brew Experience		
42	Art Show		
43	Wine Tasting		
44	Bar & Concessions		
			<b>BREAST CANCER</b>
46	Buffett Cancer Center Tent	}	<b>HISTORY, DEMONSTRATIONS*DISPLAYS</b>
48	Whipping Up Decorations & Barn Quilts		
50	History Tent		
52	Beef Exhibit		
			<b>APPENDIX CANCER</b>
54	Promise Petals	}	<b>SPONSORS*DONORS</b>
55	Serenity Garden/"Back Yard Retreat"		
56	Calf For A Cure		
60	Sponsors & Donors		
64	Trail Boss Tickets		
			<b>ALL CANCERS</b>

## ALL CANCERS

Honoring Those Affected | 3





# — 2018 CATTLEMEN'S BALL SCHEDULE OF EVENTS —

## — FRIDAY, JUNE 1, 2018 —

Golf Tournament @ Hebron Country Club	8:30-3:30pm	Miss Neb Allison Tietjen on piano	6:00-6:30pm
Helicopter Rides on site	1:00-4:00pm	Welcome	6:30-7:15pm
Gates Open for Trail Boss ticket holders	4:00pm	Live Auction	7:15-8:15pm
Concessions open	4:00pm	Miss Neb Outstanding Teen Carsyn Long	8:20-8:30pm
Silent Auction	4:00-6:30pm	Tracy Lawrence Concert	8:30-10:00pm
General Store	4:00-7:00pm	Lucas Hoge Concert & Dance	10:15-midnight
Art Tent	4:00-7:00pm		
History Tent	4:00-7:00pm		
Trail Boss Reception	5:00-6:30pm		

## — SATURDAY, JUNE 2, 2018 —

Oregon Trail Rawhide Run	7:30am	Trail Boss Luncheon	11:20-noon
Helicopter Rides on site	8:00-4:00pm	Buffet Tent & UNMC SIM Truck	12:00-4:00pm
Gates Open for Trail Boss ticket holders	8:30am	Live Auction	12:00-12:45pm
Trail Boss Champagne Breakfast & Social	8:30-10:00am	Gates open for Top Hand ticket holders	12:30pm
Antique Tractor Display	8:30-4:45pm	Main Tent closed	12:45-5:00pm
Serenity Garden & Promise Petals Tent	8:30-8:00pm	Opening Ceremonies	1:00-1:15pm
Concessions open	9:00am	Air Show	1:15-1:45pm
Silent Auction	9:00-4:00pm	Ranch Rodeo	1:45-3:30pm
General Store	9:00-4:45pm	Style Show (General Store Tent)	2:30-4:00pm
Art Tent	9:00-4:45pm	Farm and Ranch Auction	3:30-5:00pm
History Tent	9:00-4:45pm	Evening Meal lines open	5:00-6:00pm
Blacksmith demonstration	9:00-4:45pm	Truck Raffle	6:00-6:05pm
Live Animal Beef Display	10:00-4:45pm	Evening Program	6:05-7:00pm
Beef Tent	10:00-4-45pm	Live Auction	7:00-8:20pm
Main Bar opens	11:00-midnight	Trace Adkins Concert	8:30-10:00pm
Craft Beer Experience	11:00-midnight	Forgotten Highway Concert & Dance	10:00-midnight
Wine Tasting in Art Tent	10:00-4:45pm		
Main Tent opens	11:00am		





# Cattlemen's Ball Site Map

To entrance

## MAP LEGEND

- 1 -Main Tent
- 2 -Bar
- 3 -Catering
- 4 -Catering
- 5 -Meal Serving Tent
- 6 -Buffett Center/EMS Tent
- 7 -Main Entry
- 8 -Beef Tent
- 9 -History Tent
- 10-Wine/Art Tent
- 11-Cattle Shade
- 12-Silent Auction
- 13-Woodhouse
- 14-Serenity Garden
- 15-Vendor Trailers
- 16-Volunteer Food
- 17-On Site Building
- 18-Red Cross
- 19-Livestock Unloading
- 20-Cattle Display w/ Alleyway
- 21-Arena
- 29-General Store/Style Show
- 31-Storage Tent
- 34-Antique Tractor Display
- 33-Blacksmith Tent
- 36-West Bar
- 37-Grain Bin Bar
- 38-Dressing Rooms
- 40-Token Trailers
- 41-Viaero Tower

VIP & HANDICAP PARKING





# GENERAL INFORMATION

## PAYMENT OPTIONS

The Cattlemen's Ball will be using tokens for payment. Tokens may be purchased at the Auction Time Token Trailer located near the main entrance. Each token is worth \$2.00 this year. Please remember that tokens are non-refundable. Cash, check, or credit card will be accepted for purchase at the General Store, Silent Auction, and Live Auctions. Payment options may vary with individual vendors.

## LOCAL ATMS

For your convenience, there are four ATMs within two miles of the event site. *(No ATMs will be located on-site)* The following link will direct you to several nearby ATM locations: <http://bit.ly/2p2WLKy>

## AUCTIONS AND BIDDING

Auction items are subject to sales tax. Cash, checks, and debit/credit cards will be acceptable payment for your convenience. Your prompt payment following the auction is appreciated. All bids are final. No refunds or exchanges will be made.

## SERENITY GARDEN

The 2018 Cattlemen's Ball welcomes you to spend time in the Serenity Garden. This is a quiet place to rest and is provided for remembering those who fought the war against cancer and those who continue to fight each and every day. The Serenity Garden area reminds us of the most important reason we are here -- to raise money for cancer research, to honor those who have fought the battle and to offer hope to those still fighting cancer. Thank you to each of you

for your part in helping "Whip Cancer"!



6 | Overview

## FIRST AID

EMTs will be on site to provide care for any medical situations. The EMT's are located in the Buffet Tent (*please see map*) to assist with any medical emergency.

## DISCLAIMER NOTICE

This disclaimer notice and release is valid and automatically considered as accepted by all guests by their presentation of a ticket and entrance to the grounds of the Event.

By presenting a ticket for admission to and entering the grounds of The Cattlemen's Ball of Nebraska 2018 (the "Event"), guests attend at their own risk. The Cattlemen's Ball of Nebraska Inc., Hergott Farm, and 2018 CBN Hosts, Inc., their Officers, Directors, Members, Partners, Managers, Co-chairs, Committee Members, their agents and volunteers (collectively referred to as "Event Providers") shall not be liable for and disclaim all liability for any claims of whatever nature including but not limited to that for theft, injury, loss or damage of whatever nature, against the Event Providers, whether arising from the default, negligence or otherwise, of any one of more Event Providers and guests further waive any claim of any nature in their own right and on behalf of anyone claiming through them.

**CONSENT TO USE OF IMAGE OR LIKENESS:** Entry upon the grounds of the 2018 Cattlemen's Ball of Nebraska constitutes consent and permission to use all entrants' likeness or image at any time in future in photographs, video and any other promotional materials related to The Cattlemen's Ball of Nebraska 2018 and all future Cattlemen's Ball of Nebraska events.

Lost and Found items are located in the Token Trailer during the Cattlemen's Ball.

After the Ball contact Roger Fehr at  
[rfehr@superiorinet.net](mailto:rfehr@superiorinet.net)  
or (402) 469-8341



FORWARD THINKING SOLUTIONS

# FOR HOME AND BUSINESS

## RESIDENTIAL

Reliable high-speed Internet, Cable TV, and Phone services to match the needs of your household



## BUSINESS

Customized business solutions including high-speed Internet, managed-Ethernet, and multiple voice options for businesses from small storefronts to large enterprises



**Visit our website or call to find out what's available in your area.**

888-343-8014 | [www.gpcom.com](http://www.gpcom.com)





# PROUD SUPPORTER OF THE **CATTLEMEN'S BALL OF NEBRASKA**



## **SERVING THE TRANSPORTATION INDUSTRY SINCE 1884**

A lot has changed in 134 years since Timpfe Brothers first opened in 1884. Timpfe has continuously set the transportation industry's standard for quality and innovation. Today we are the largest manufacturer of bulk commodity trailers in North America and we custom build every trailer in David City, Nebraska.

# **TIMPTE.**

*Since 1884*

**1827 Industrial Dr. | David City, NE | [Timpfe.com](http://Timpfe.com)**





Rob & Natalie Marsh, Addison (9)  
Leah (7) Brynn (5) and Kora (2)

## 2018 HOST FAMILIES

Welcome to the 2018 Cattlemen's Ball held on the Hergott Farm right next to the historic Oregon Trail. This is the 21st annual Ball and we are excited and honored for the opportunity to host you for a fantastic weekend. This year we have many wonderful activities and events for you to enjoy. We feel we truly have something for everyone to experience.

A little about our families: Randy & Becky Hergotts' roots run very deep as their family has farmed and raised cattle in the Hebron area since the 1870's. Today they are in ag equipment sales as well as the family farm operation. They have 5 sons, Jim, Chris, Colby, Jordan and Cale and with their families they have 7 grandkids.

Rob & Natalie Marsh farm and raise cattle northeast of the Ball site. Their commercial cow-calf herd is made up of Red Angus cows that calve in the fall. Rotational grazing of irrigated pasture, native grasses, corn stalks and dry lot scenarios are used in the operation. Rob & Natalie have 4 daughters, Addison, Leah, Brynn and Kora who are the 7th generation on the farm.

This event is the culmination of countless hours of planning by so many volunteers. A BIG thank you to our Chair Couples: Tony & Karla Deepe, John & Lynn Greer, Pat & Carlece Kenner, Mike & Ellen Long, Dick & Cheryl Walsh and Gregg & Janice Wiedel. These six couples embraced the challenge of putting together a great Ball. They understood from day one that this special weekend is all about raising money for Cancer research. They poured their hearts into this and it has definitely paid off. Our sincere thanks also go out to the chairmen and volunteers from communities near and far that made up the 50 committees it took to plan this fundraiser.

We would like to thank those that have graciously made donations this past year. Your generosity to fund this event was truly inspiring. Lastly thank you to all members of the Ball Advisory Board and Executive Secretary Deb Hansen for your confidence in us and advice over the last couple years.

Once again Welcome and Thank You for joining us. With your help and generosity we will hit our goal of giving a major financial gift to the Buffett Cancer Center and to also give back to our local communities' health & wellness projects.

To beat Cancer we need to fund the research!  
Let's do this Together, because Together...we can "WHIP CANCER"  
Randy & Becky Hergott and Rob & Natalie Marsh



Left to Right: Robbin, Alexis, Colby, Brooklyn, Chris, Brighton, Staci, Keith, Cassie, Jim, Tegen, Tori, Takaylynn, Randy, Becky Hergott, Jordan, Dani and Cale Pharris

# KIDNEY ★ LIVER CANCER

Honoring Those Affected | 9





## WELCOME TO THE 2018 CATTLEMEN'S BALL

We simply cannot begin to express our gratitude that you are here, joining us for the 2018 Cattlemen's Ball of Nebraska. We have an amazing event planned for you and we hope you will enjoy every minute of it.

For those of you who are experiencing your very first Cattlemen's Ball event, we say a huge "Welcome to the family!"

Because, here at The Cattlemen's Ball, we are all like family – gathering together, supporting each other, and supporting an incredibly worthy cause: the quest to find a cure for cancer!

For the many of you who choose each year to make the Cattlemen's Ball of Nebraska event the official kick-off to your summer, we offer a firm handshake and a hug, along with a "We're glad to see you again!"

We would like to especially thank our Host & Hostess, Randy and Becky Hergott, and also our Co-Host & Co-Hostess, Rob and Natalie Marsh, and both of their families. These two couples have logged countless hours preparing for this weekend, and their work is evident in everything you see around you. Their dedication and drive kept all of us motivated and striving to reach our team goals.

We also want to thank our many Committee Chairmen and all of their committee members – this has been an area-wide effort that we are so very proud of and thankful for. Our "involvement" map is an unprecedented 50+ communities strong! From out of these communities came some amazing leadership. You took on so much responsibility and worked as if this event was your very own. For you, and for all you have done to make this event a resounding success, we are truly grateful.

Finally, for all the hours and energy spent by our pre- and post-event volunteers, your work and talent has been priceless; And for all of our on-site volunteers who have invested of themselves, not only to help with all aspects of these two magnificent days, but also by giving of their own private funds with a genuine willingness to help wherever they were needed – we tip our hats to you.

We could not do any of this without you, either.

Whether you are a Trail Boss, or a Top Hand, we now want you, as a guest, to experience every activity and opportunity the 2018 Cattlemen's Ball has to offer – remembering that all you graciously give becomes a gift of hope to someone. Your auction bids and other giving opportunities, they are the things that dreams are made of – dreams of a world without cancer. They are priceless gifts that can miraculously turn into one more day, one more week, one more year or more that someone can spend in this world enjoying their loved ones. Your heartfelt gifts, both large and small, combine specifically to make cutting edge cancer research and breakthrough developments possible. Together we CAN do this. Together, we can WHIP CANCER!

With that, we extend our hands and whole-heartedly welcome you to Thayer County, Nebraska – authentic Oregon Trail country! God bless you and God bless your kind hearts as we all enjoy our time together, "Whipping Cancer Down the Oregon Trail" at the 2018 Cattlemen's Ball of Nebraska!



## CO-CHAIR FAMILIES



Dick & Cheryl  
Walsh



Mike & Ellen  
Long



Pat & Carlee  
Kenner



John & Lynn  
Greer



Gregg & Janice  
Wiedel



Tony & Karla  
Deepe





Front Row (left to right): Becca Weborg, Laurie Widdowson, Ray Bennett, Suzanne Jagels, Kae Pavlik.  
Back Row (left to right): Kevin Rasmussen, Darreld Saltzman, Dick Miles, Bill Pullen, Al Svajgr, Larry Shavlik, Ivan Rush, Deb Hansen



## ADVISORY BOARD

Welcome to the 2018 Cattlemen's Ball of Nebraska at the Hergott Farm in Hebron, Nebraska. On behalf of the Advisory Board, I thank you for attending and hope you have an enjoyable day supporting the 21st Ball and the continued challenge of funding cancer research. Throughout the 20 years of the Cattlemen's Ball of NE, the Fred

and Pamela Buffett Cancer Center has received over \$13 million for research. With your generosity, we will continue to make a difference in finding a cure to WHIP CANCER.

This year we thank Randy and Becky Hergott and Rob and Natalie Marsh and their families for co-hosting the 2018 event. We are grateful for co-chairs: John and Lynn Greer, Mike and Ellen Long, Gregg and Janice Wiedel, Pat and Carlece Kenner, Dick and Cheryl Walsh, and Tony and Karla Deepe. Their teams of enthusiastic volunteers deserve cheers of gratitude for the time and energy spent organizing this event. We also thank the numerous sponsors for auction items and financial support. Without your generosity the Cattlemen's Ball of NE would not be successful.

While here at the Hergott Farm, take time to enjoy the setting in rural Nebraska, partake in the auctions and activities planned for the weekend, meet up with friends and maybe make some new ones, and dine on delicious Nebraska beef.

The Advisory Board is pleased to announce Derek & Allison Sandman & Wayne & Chris Krausnick, of Wauneta, NE as the hosts of the 2019 Ball. It will be held on June 7 and 8, 2019. We hope you are able to join us.

Until then, be safe and continue your support to WHIP CANCER.

Ray Bennett  
Advisory Board Chairman

**KIDNEY ★ LIVER CANCER**

Honoring Those Affected | 11







## FROM THE GOVERNOR

Dear Friends:

Welcome to the 21st Annual Cattlemen's Ball of Nebraska!

Thank you all for coming together and celebrating Nebraska's rich agricultural heritage. Beef production is our largest industry, and it is growing. This growth is vital to Nebraska's continued success. Nebraska is first in the nation in beef and veal exports as well as cattle on feed, second in the nation for all cattle and calves, and we are home to the top three beef cow counties in America. I'm glad to share with you that Nebraska experienced big growth in our beef industry in 2017. Nebraska's total beef exports increased by 12 percent last year. This increase made Nebraska the largest beef exporting state in the U.S. for the second year in a row. We exported \$1.26 billion worth of beef. That's great news for our state! Your accomplishments make Nebraska successful.



Nebraska's quality of life has grown along with the success of Nebraska's farm and ranch families. We are known across the nation and around the globe as hard-working, industrious, innovative people who produce quality products that feed the world. These qualities, inspired by the work ethic and character of our farm and ranch families, are embedded in the Nebraskan tradition. Virtues like these are why Nebraska is the best place in the world to live, work, and raise a family. When people move to Nebraska, they know that they're moving to a state with civically-minded families who are involved in their communities, their schools and their churches. Nebraska's cattlemen exemplify this spirit through this event. The Cattlemen's Ball is a great example of the kind of initiative that comes from our unique Nebraska commitment to serving our neighbors.

Susanne and I would like to offer a special thank you to all of the volunteers and donors that have made this year's Cattlemen's Ball possible. Ninety percent of today's proceeds will benefit the Fred & Pamela Buffett Cancer Center in Omaha, which is helping Nebraska become a leader in cancer treatment research. With your support, the University of Nebraska Medical Center is taking innovative new steps towards a cure for cancer. The remaining 10 percent is donated to local health and wellness programs. This commitment to our state and our communities is incredible.

Thank you all for everything you do for Nebraska's agriculture industry and for your commitment to finding a cure for cancer. God bless you in your work, and God bless the great State of Nebraska!



Sincerely,

Pete Ricketts  
Governor



# 2018 CATTLEMEN'S BALL COMMITTEE CHAIRMEN



**Bar Committee**

Left to Right: Colt Vieselmeyer, Jerry Johnson, Andrew Fangmeier, Haley Williams, Justin Williams, Chris Huber, Steve Williams



**Style Show Committee**

Left to Right: Tara Huber, Natalie Marsh, Jamie Koch



**Art Tent Committee**

Left to Right: Jerry & Virginia Brase, Jenise Straight, Susie & Gary Miller



**Golf Cart Shuttles**

Scott & Paula Schroeder



**Outdoor Decorations:**

Becky & Tori Hergott



**Air Show:** Bill Linton



**Calf-For-A-Cure Program:**

Bob Engle & Tim Else



**Auctioneers/Clerks:** Brad Elting



**CPA:** Brian Blobaum



**Main Tent Coordinator:**

Christy Farnstrom



**Lost & Found:**

Roger & Chris Fehr (Not Pictured: Ron and Ann Lindvall)



**Buffett Center Tent:**

Marla Heitmann

**KIDNEY ★ LIVER CANCER**

Honoring Those Affected | 13







## 2018 CATTLEMEN'S BALL COMMITTEE CHAIRMEN



**Tokens:** Rick & Patrice Hoffman



**General Store:**  
Diane Baxa & Idonna Kripal



**Opening Ceremonies:**  
Jane Dodes



**Promise Petals:**  
Janelle Bruning



**Beef Display/Exhibit:**  
Jason Jagels & Neil Voss



**Rawhide Run:** Jeff Friesen



**Memorabilia:**  
Jordan Sales &  
Denese Sudbeck



**Silent Auction:** Kory Koch



**History Tent:** Linda Simonsen



**Ticket Sales:**  
Lindsey Vieselmeyer



**Tokens:**  
Max & Karen Hinrichs



**Catering/Serving:**  
Janice Wiedel







## 2018 CATTLEMEN'S BALL COMMITTEE CHAIRMEN



**VIP Assistance:**  
Megan & Chad Oswald



**Truck Raffle:**  
Mike Schroeder  
& Darrel Springer



**Interior Decorations:**  
Nancy Hofts



**Oregon Trail Video:**  
Phil & Deb Johnson  
(Not Pictured, Pam Maynard)



**Horseback Parking:**  
Carrie Anderson & Dick Heinrichs



**Golf Tournament:**  
Ron Dubbert



**Air Show:** Scott Harms



**Wine Tasting:** Shelley Bursik



**Live Auctions:** Tara Kuhlmann



**Treasurer/Cashier:**  
Traci Fangmeier & Craig Pope



**EMS:** Wayne Kugel



**Ranch Rodeo:**  
Trey Duensing & Spenser Else

**KIDNEY ★ LIVER CANCER**

Honoring Those Affected | 15





# 2018 CATTLEMEN'S BALL COMMITTEE CHAIRMEN



**Grounds, Electrical & Communications:**  
Randy & Jim Hergott



**Volunteer Coordinator, Secretary & Sanitation & Lodging:**  
Pat & Carlece Kenner



**Underwriting:**  
Dick Walsh



**Camping:**  
Kevin & Larry Hergott



**Entertainment:**  
Lance Pachta & Rob Marsh



**Security:**  
David Lee



**Trailer Shuttles:** Tysen Hissong



**Photography:** Art Whitton



**Golf:**  
Eric Krupicka & Thad Mumm



**Landscaping:** Ben Ulmer



**Program Design**  
Lena Garner







## DR. COWAN ADDRESS

We are in beautiful southeast Nebraska at the Hergott Farm this weekend to “Whip Cancer.” On behalf of the faculty and staff of the Fred & Pamela Buffett Cancer Center, thank you for your generous support of cancer research at Nebraska’s only National Cancer Institute (NCI)-designated Cancer Center.

I want to express my gratitude to the people of Thayer County and the surrounding communities who worked together for so many months to make the 2018 Cattlemen’s Ball happen. Thank you to this year’s co-hosts, Randy and Becky Hergott and Rob and Natalie Marsh and their families, for your hospitality, commitment and passion for the Cattlemen’s Ball. I would also like to express my gratitude to the event chairs for your hard work: Mr. and Mrs. John Greer, Mr. and Mrs. Pat Kenner, Mr. and Mrs. Mike Long, Mr. and Mrs. Dick Walsh and Mr. and Mrs. Gregg Wiedel. Many thanks to Cattlemen’s Ball Advisory Board president Ray Bennett, and the entire board, for your leadership and support of this special event for over 20 years. I would also like to thank the committee chairs, committee members, and the hundreds of volunteers for your time and efforts. Finally, on behalf of the faculty, staff and patients of the Fred & Pamela Buffett Cancer Center, we thank each of you for attending this year’s Cattlemen’s Ball.

Breakthroughs in cancer research happen everyday, but they can only happen with your help. Every person who generously gives to the Cattlemen’s Ball is a partner with the Buffett Cancer Center in fighting cancer. Scientists at the Fred & Pamela Buffett Cancer Center are eligible for pilot project funding through Cattlemen’s Ball funds. Pilot projects help researchers develop preliminary results necessary for submitting larger federal grant applications. The Cattlemen’s Ball also makes competitive start-up packages possible for Fred & Pamela Buffett Cancer Center researchers. These packages are crucial to recruiting and retaining the brightest and most talented cancer researchers. Specialized equipment that is shared by scientists at the Fred & Pamela Buffett Cancer Center is also supported by funds from the Cattlemen’s Ball. Finally, the Cattlemen’s Ball generously supports the state-wide clinical trials program, which provides access to all cancer clinical trials at the Fred & Pamela Buffett Cancer Center to patients across the state.

Thank you for being a part of the 2018 Cattlemen’s Ball! With your help, the Fred & Pamela Buffett Cancer Center will “Whip Cancer!”

Kenneth H. Cowan, M.D., Ph.D.  
Director, Fred & Pamela Buffett Cancer Center

**KIDNEY ★ LIVER CANCER**

Honoring Those Affected | 17





# TRAIL BOSS

**SPONSORED BY**  
**BRUNING**  
**STATE**  
**BANK** Member FDIC

## RECEPTION ★ AUCTION

— FRIDAY, JUNE 1, 5:00 PM —

### — AUCTION ITEMS —

- #101 Choice of 1 Top Cut Black Angus Heifer  
Bruning Farms; Bruning, NE

---

- #102 Custom Engraved Henry Golden Boy  
22 cal. Rifle Serial #9  
Sponsored by Lenny & Carla Bowman

---

- #103 Tracy Lawrence Meet & Greet Passes for 4  
Sponsored by: Acre Management;  
Sprague, NE

---

- #104 Magnum Bottle of the 2018  
Cattlemen's Ball Custom Etched  
"The Sheriff" Collector's Edition Wine  
Shelley Bursik Kuzma (Boisset Collection)

---

- #105 "One of a Kind" Coffee/End Table with  
Cattlemen's Ball Logo Branded  
2017 Cattlemen's Ball Hosts  
Donated by: Lonesome River Ranch

---

- #106 Stained Glass Hanging  
Ann Miles; McCool Junction, NE

---

- #107 Ornamental 10ft Weather Vane  
Bob & Jodi Else; Belvidere, NE  
Spenser & Jessica Else; Belvidere, NE

---

- #108 Wine Barrel Table Bar  
Alf's Well Drilling; Shickley, NE

---

- #109 Husker Experience with Jane and  
Chancellor Ronnie Green  
Two Tickets Each, Football, Volleyball, Men's  
Basketball, Women's Basketball and Baseball.  
Football game will include The  
Chancellor's Pregame Event and  
Skybox Seats

- #110 Memorial Stadium Photo Signed by  
Scott Frost  
University of Nebraska - Lincoln

---

- #111 7 Night Punta Gorda Florida Waterfront  
Condo with 2 Delta Flight Vouchers  
Lisa Levendofsky, Sun City, FL  
Flight Vouchers sponsored by Travel and  
Transport; Omaha, NE

---

- #112 Custom Engraved Henry Golden Boy  
22 cal. Rifle Serial #8  
Sponsored by: Doug & Cindy Lottman

---

- #113 Unique 2018 Cattlemen's Ball Bronze  
Sculpture (1 of 5)  
Vern Friesen Gallery; Henderson, NE  
Co-sponsored by Renewable Fuel of  
Nebraska

---

- #114 Unique 2018 Cattlemen's Ball Bronze  
Sculpture (2 of 5)  
Vern Friesen Gallery; Henderson, NE  
Co-sponsored by Renewable Fuel of  
Nebraska

---

- #115 2018 Polaris Sportsman 450 ATV  
Bruna Implement; Washington, KS

---

- #116 1 Week Wyoming Lodging in a Hunting  
Cabin in Big Horn National Forest  
Ernie Weyeneth; Lincoln, NE

---

- #117 4 Person - Full Day Pheasant Hunt with  
Lunch, Birds Cleaned, Guided & Dogs  
Rod & Lorita Zohn; Jamestown, KS  
Stephan & Rachel Zohn; Jamestown, KS

### — MENU —

USDA Choice Beef Kabobs  
 Chef's Western Style Beef Brisket Sliders  
 Glazed Sweet Chili Sauce Meatballs  
 Chef's Gourmet Shrimp Sautee Station  
 Vegetable Crudites  
 Spiced Tortilla Rollups  
 Homemade Spinach & Artichoke Dip  
 Assorted Desserts

- #118 Lucas Hoge Meet & Greet Passes for 4  
Sponsored by: Acre Management; Sprague, NE

---

- #119 Southwest Print Queen Quilt  
Valarie Bard; Hardy, NE

---

- #120 Yellow Gold Diamond Circle Pendant  
Borsheim's Jewelry; Omaha, NE

---

- #121 Live on stage painting by Allison Fees  
Varah  
Allison Fees Varah; Ansley, NE

---

- #122 Private Dinner for 8 at the Governor's  
Mansion  
Office of Governor Pete Ricketts

---

- #123 Customized 2018 Cattlemen's Ball Bench  
Minden Machine Shop; Minden, NE

---

- #124 Custom Engraved Henry Golden Boy  
22 cal. Rifle Serial #7  
Sponsored by: Hebron Plumbing Inc.  
Rich & Cheryl Koch



### EVENING MC: JOHN ★ TARYN VANDERFORD

We're honored to welcome husband and wife, Jon and Taryn Vanderford as our Friday evening emcee's. Jon is the host, reporter and executive producer for 10/11's Pure Nebraska. He co-anchors the show with his wife, Taryn, and Meteorologist Brad Anderson. In addition to Pure Nebraska, Taryn also anchors 10/11 This Morning weekdays from 5-7 a.m. She is also a Moms Everyday host weekdays at 8:55 a.m. These two well-known television personalities are no strangers to rural Nebraska. Both are natives - Jon grew up near the village of Murdock and Taryn grew up near Pender.





# TRAIL BOSS

## CHAMPAGNE BREAKFAST

— SATURDAY, JUNE 2, 8:30 AM —



SPONSORED BY

**FILLMORE**  
COUNTY HOSPITAL

### MENU

Breakfast Frittata Casserole

Assorted Pastries

Tropical Fresh Fruit

Orange Juice

Coffee

## COMPLIMENTARY BEVERAGES

BLOODY MARY'S  MIMOSAS

— CHAMPAGNE MIMOSA BAR —

SPONSORED BY

NEBRASKA

TITLE

COMPANY

SERVICE BEYOND EXPECTATION



**BONE ★ CHILDHOOD CANCER**

Honoring Those Affected | 19





# TRAIL BOSS

## LUNCHEON

— SATURDAY, JUNE 2, 11:15 AM —

SPONSORED BY

**HERBSTER**  
ANGUS FARMS

### MENU

USDA Choice New York Strip  
Seasoned Baby Russets  
Glazed Petite Carrots  
Perfect Summer Salad  
Rolls and Butter  
Lemonberry Jazz Dessert

## — AUCTION ITEMS —

NOON MC • TREVOR STEINMEYER

- #201 Custom Engraved Henry Golden Boy  
22 cal. Rifle Serial #6  
Sponsored by: Darrel Springer

---

- #202 Carpenter Star Handmade Quilt  
Marge Buescher; South Bend, NE

---

- #203 Open Cockpit Tour of the City of Lincoln  
for 1 person in a WWII Boeing  
Duncan Aviation, Lincoln, NE

---

- #204 Magnum Bottle of the 2018  
Cattlemen's Ball Custom Etched  
"The Sheriff" Collector's Edition Wine  
Shelley Bursik Kuzma (Boisset Collection)

---

- #205 Husker Print  
The Home Agency; Elwood, NE

---

- #206 4 University of Nebraska Football  
Skybox Tickets to Michigan State Game  
Gov. Pete Ricketts &  
First Lady Susanne Shore

---

- #207 Custom Engraved Henry Golden Boy  
22 cal. Rifle Serial #5  
Sponsored by: Darrel Springer

- #208 Customized 2018 Cattlemen's Ball Bench  
Minden Machine Shop; Minden, NE

---

- #209 Upland Game Re-Stocking Package  
200 Fertilized Laying Pheasant Hens;  
20 Roosters; 50 Bobwhite Quail for pickup  
in late June 2018 Double Barrel Game Farm  
& Hatchery  
McCool Junction, NE

---

- #210 Small Game Hunt South of Lincoln  
Beebe Outdoors; Bennet, NE

---

- #211 Private Curated Collectors' Wine &  
Food Tasting Experience for 12  
Shelley Bursik Kuzma (Boisset Collection)

---

- #212 5 Night Winter Park Colorado  
Vacation Package includes \$1000  
Winter Park Voucher  
Nancy Germer; Englewood, CO

---

- #213 John Deere Gator  
Landmark Implement; Holdrege, NE

---

- #214 Cub Cadet Mower  
M&M Trailer Supply; Palmyra, NE

---

- #215 10 Units of Semen on Reserve  
Champion Hereford  
KJBJ 582 Contender  
Kevin & Sheila Jensen; Courtland, KS

---

- #216 Unique 2018 Cattlemen's Ball Bronze  
Sculpture (3 of 5)  
Vern Friesen Gallery; Henderson, NE  
Co-Sponsored by Renewable Fuel  
of Nebraska



- #217 Unique 2018 Cattlemen's Ball Bronze  
Sculpture (4 of 5)  
Vern Friesen Gallery; Henderson, NE  
Co-Sponsored by Renewable  
Fuel of Nebraska

---

- #218 Custom Engraved Henry Golden Boy  
22 cal. Rifle Serial #4  
Sponsored by: Darrel Springer





# TRAIL BOSS

## TOP HAND EVENING MEAL

**SPONSORED BY**

 **Thayer County Health Services**

**AND THAYER COUNTY HEALTH SERVICES FOUNDATION**

Table Wine Sponsored By:

FUTURES ONE fields of opportunity

BROKERAGE • RISK MANAGEMENT • MARKET ANALYSIS

**— SATURDAY, JUNE 2, 5:15 PM —**

### **— MENU —**

Certified Angus Beef Prime Rib

Bistro Style Garlic Mashed Potatoes

Classic Caesar Salad

Garden Pasta Salad

Rolls and Butter

Dessert Array



**EVENING MC  
MIKE FLOOD**



## **— AUCTION ITEMS —**

#401 Custom Engraved Henry Golden Boy  
22 cal. Rifle Serial #3  
Sponsored by Darrel Springer

#402 4 Person Lac Suel, Canada Fishing Trip  
September 1-8  
Rod & Lorita Zohn; Jamestown, KS  
Stephen & Rachel Zohn; Jamestown, KS

#403 "Nebraska Skies" 96x108 Quilt  
Thayer County Quilt Guild

#404 Trace Adkins Meet & Greet Passes (4)  
Sp. by: Acre Management; Sprague, NE

#405 Dbl Mag. Bottle, 2018 Cattlemen's Ball  
Custom Etched "The Sheriff" Collector's Edition  
Wine autographed by Tracy Lawrence  
Shelley Bursik Kuzma  
Jean & Charles Boisset

#406 Dbl Mag. Bottle, 2018 Cattlemen's Ball  
Custom Etched "The Sheriff" Collector's Edition  
Wine autographed by Tracy Lawrence  
Shelley Bursik Kuzma  
Jean & Charles Boisset

#407 Aerial Photo Signed by all  
head coaches & Bill Moos  
University of Nebraska - Lincoln

#408 "2 Football Tickets in the  
President's Skybox  
Office of the President,  
University of Nebraska; Lincoln, NE

#409 1950 Ford Antique Car  
Patricia Schardt / Schardt Foundation

#410 2018 Lil Sport 510 Pontoon Boat with  
Shorelander Trailer, Canopy & 2 Seats  
Hotwoods; Grand Island, NE

#411 Cattle Painting  
Ashley Spitsnogle; Omaha, NE

#412 3x4 Canvas Painting of Head Coach  
Scott Frost "The Return"  
Ashley Spitsnogle; Omaha, NE

#413 Cubs Dream Day  
Governor Pete Ricketts and  
First Lady Susanne Shore

#414 Custom Engraved Henry Golden Boy  
22 cal. Rifle Serial No. 2  
Sponsored by Darrel Springer

#415 2018 Yamaha Quiet Tech Golf Cart  
Superior Outdoor Power; Superior, NE

#416 Ornamental 15ft Weather Vane  
Geneva Welding; Geneva, NE

#417 Antique Street Lamp  
Don Deitemeyer; Doniphan, NE

#418 Back Yard Retreat  
Sponsors on Page 55

#419 Easiload Seed Tender 2 Box Lo Pro  
Clark's Ag Supply; Clarks, NE

#420 Silencer Hydraulic Chute-Ranch Model  
Pivot Controls, Hydraulic lower squeeze,  
Additional neck access, Rubber belted louvers,  
2 Neck Bars, SHP 1PH Electric Motor (220v)  
Dubas Equipment LLC, Fullerton, NE

#421 2018 Titan Stock Trailer  
Titan Manufacturing; Waterville, KS

#422 2019 Timpte Grain Hopper Trailer  
Timpte Inc; David City, NE

#423 Reinke 1292' Center Pivot  
Reinke Manufacturing Inc; Deshler, NE

#424 Reinke Ell Swing Arm Retro  
Reinke Manufacturing Inc; Deshler, NE

#425 Grain Bin Bar  
Rob & Natalie Marsh; Gregg & Janice  
Wiedel; Mike & Ellen Long; John &  
Lynn Greer and Dick & Cheryl Walsh

#426 Unique 2018 Cattlemen's Ball Bronze  
Sculpture (5 of 5)  
Vern Friesen Gallery; Henderson, NE  
Co-sp. by Renewable Fuel of Nebraska

#427 Custom Engraved Henry Golden Boy  
22 cal. Rifle Serial # 1  
Sponsored by Nate & Kristi Casey in memory  
of Marlene Casey & Twila Widman

#428 "Surprise"

# **BONE ★ CHILDHOOD CANCER**

Honoring Those Affected | 21





# FARM ★ RANCH AUCTION

**#301 Henry Golden Boy**  
22 cal. Rifle Serial No. 16  
Sp. by: Brad Coordsen Memory of Walter Coordsen

**#302 6 Bags RR Alfalfa**  
Channel Seed, Jerry & Heidi Miller, Fairbury, NE

**#303 Steel Flatbed for Pickup**  
Bradford Built, Inc., Washington, KS

**#304 Portable Panel Trailer with 30  
5'X10' Portable Catch Panels**  
Linn Post & Pipe Supply, Inc., Linn, KS

**#305 Nelson R3030 Sprinkler Package  
for Standard 1/4 Mile Pivot**  
William's Drilling Co., Inc., Belvidere, NE

**#306 John Deere Zero Turn Mower**  
Plains Equipment Group

**#307 ADS Mineral Matron & Cattle  
Mineral Feeder**  
Ag Dryer Services, Inc., Elm Creek, NE

**#308 Senninger Xcel Wobbler Sprinkler  
Package for Center Pivot**  
Southeast Valley Irrigation, Bruning, NE

**#309 Concrete Retaining Wall Blocks  
10 - 2'X2'X6'**  
Daykin Lumber Co., Bruning Lumber Co.

**#310 8 Bags Dekalb Seed Corn**  
Norder Supply, Inc., Bruning, NE

**#311 27 Ton Load of Wet Distillers Grain**  
Oswald, Inc., Shickley, NE

**#312 160 Acres Application of Fertilizer**  
Bruning Grain & Feed Co., Inc., Bruning, NE

**#313 8 Bags Channel SmartStax Corn**  
Darren & Denese Sudbeck, Hebron, NE

**#314 HBL 84-2 Medium Duty Rear Blade  
for 30-75 hp Tractor**  
Woods Equipment Co./Hergott Enterprises, Inc.

**#315 T3000 Industrial Air Filtration Unit**  
Industrial Maid, LLC., Cortland, NE

**#316 J480 Johnson Concrete Waterer**  
Johnson Concrete Products, Hastings, NE

**#317 J360 Johnson Concrete Waterer**  
Johnson Concrete Products, Hastings, NE

**#318 Pedal Tractor, Survivor Color**  
KanEquip, Inc., Syracuse, NE

**#319 1 Month Skid Loader Rental**  
KanEquip, Inc., Syracuse, NE

**#320 1000 Ft. 6 Bar 13 GA Continuous Fencing**  
Feedlot Fencing, LLC., Bruning, NE

**#321 1 Full Cattle Shade**  
Feeding Systems, LLC., Columbus, NE

**#322 M Series Self Catch Headgate**  
Behlen Country, Columbus, NE

**#323 10K Chute Scale with Avery  
Weigh-Tronix Readout**  
Central City Scale, Central City, NE





# FARM ★ RANCH AUCTION

#324 **1 Pair Steel Tread Center Pivot Wheels**  
BB's Metal Works, Inc., York, NE

#325 **320 Acres of Grid Sampling,  
2.5 Acres Grid**  
On The Hill Ag, Adams, NE

#326 **10-38" Irrigation Tires on  
Galvanized Wheels**  
Outdoor Tire, LLC., Omaha, NE

#327 **1 Month Rental of Komatsu WA270  
Wheel Loader**  
RoadBuilders Machinery & Supply, Grand Island, NE

#328 **8 - 225 lb Wind & Rain Availa  
4 Mineral Tubs**  
Blunk Feed/Purina Animal Nutrition, Bruning, NE

#329 **1 Set ATV Ramps**  
Prairie View Industries, Inc., Fairbury, NE

#330 **1 Set ATV Ramps**  
Prairie View Industries, Inc., Fairbury, NE

#331 **1 Month Rental of John Deere 320E  
Skid Steer**  
Murphy Tractor & Equipment Co., Lincoln, NE

#332 **1 Month Rental of John Deere  
544K Wheel Loader**  
Murphy Tractor & Equipment Co., Lincoln, NE

#333 **S04 Squeeze Chute**  
Priefert Manufacturing Co., Inc.  
Mount Pleasant, TX

#334 **40 Units Pioneer Soybeans**  
Long Crop Service, Hebron, NE

#335 **1 Month Rental of 12 Yard Heavy  
Duty Box Scraper**  
Strobel Manufacturing, Inc., Clarks, NE

#336 **100 Bags of Concept-Aid 5**  
BioZyme, Inc., St., Joseph, MO

#337 **System 8-10 Tower Winter Inspection**  
Concordia Tractor, Inc., Concordia, KS

#338 **14 Day Rental of Feed Mixer Truck**  
Mid America Truck Equipment, Belleville, KS

#339 **Transfer Pump with Honda Motor**  
Stanton Farm Services, Inc., Fairbury, NE

#340 **1 Month Rental of Ag Sidump'r**  
Sidump'r Trailer, Columbus, NE

#341 **T & S Trip Hopper 2000lb. Cake Feeder**  
Bill's Volume Sales, Inc., Central City, NE

#342 **18.5 Ton Galvanized Feed Bin  
with Ladder & Auger**  
Hog Slat, Inc., Newton Grove, NC

#343 **Rental of Challenger 1000 for 50 Hours**  
Butler Ag Equipment, Pickrell, NE

#344 **Henry Golden Boy  
22 cal. Rifle Serial No. 17**  
Sponsored by: Joey & Audra Hergott Family"

## OVARIAN ★ CERVICAL CANCER

Honoring Those Affected | 23





# 

#501 **Football Signed by Coach Scott Frost**  
University of Nebraska-Lincoln

#502 **Basket of Sugar Shack Products**  
Sugar Shack Country Candles, Edgar, NE

#503 **2 – O2 Beam Flashlights**  
Davenport Building Supply, Davenport, NE

#504 **150th Oregon Trail Belt Buckle, #56**  
Sallie Pfeifer, In Memory of Dale Pfeifer, Davenport, NE

#505 **Wine with Glasses, Coaster & Blanket in a Basket**  
Sojka Sisters, Lincoln, NE

#506 **Hand Painted Barnwood Sign**  
Denise Dove, Belleville, KS

#507 **Hand Painted Welcome Saw**  
Denise Dove, Belleville, KS

#508 **Framed "Western" Picture**  
Ron Huss, Lincoln, NE

#509 **Cribbage Board, Handmade (1 of 3) Each with a Different Design (Cattlemen's Ball Logo, etc)**  
Doug & Janelle Bruning Bruning, NE

#510 **Cribbage Board, Handmade (1 of 3) Each with a Different Design (Cattlemen's Ball Logo, etc)**  
Doug & Janelle Bruning Bruning, NE

#511 **Cribbage Board, Handmade (1 of 3) Each with a Different Design (Cattlemen's Ball Logo, etc)**  
Doug & Janelle Bruning Bruning, NE

#512 **Set of 3 - 16" x 20" Acrylic Canvas Paintings, Signed with Description on Back**  
Minette Tomasch, Fairbury, NE

#513 **"Tulips in Morning Sun" Water Color Painting**  
Sharon Keys' Art, Centennial, CO

#514 **Winegard Carryout 6-2 Satellite (Dish & DirecTV Compatible)**  
Rich & Sons RV, Grand Island, NE

#515 **Handmade Skinning Knife**  
Ely Knives and Silver, Grafton, NE

#516 **Handmade Sterling Silver Bracelet**  
Ely Knives and Silver, Grafton, NE

#517 **Glock Carrying Bag, T-Shirt & Hoodie**  
Sorenson Corner Market, Edgar, NE

#518 **ESAB Warrior Tech Auto Darkening Welding Helmet, 2yr Warranty**  
Island Welding Supply Co., Grand Island, NE

#519 **Windmill Clock & Gift Certificate**  
Blue Blossom, Friend, NE

#520 **Door Hang Package, "Snow Flake, Watermelon & Hello"**  
The Freckled Door, Friend, NE

#521 **Bloody Mary Basket with all the essentials**  
Weber Feedyard, D orchester, NE

#522 **Health & Happiness in the Heartland Basket", Apple Watch, Tumbler, Wine, "Thankful" Wood Sign**  
Milligan Insurance Agency, Milligan, NE

#523 **50"x60" Multi Tapestry Throw called, "Sunday Social Club" & Tote Bag**  
Elizabeth Hofmann, Sutton, NE

#524 **"Laura Landon on Glass", 3 Author-Signed Books, Wine & Glasses**  
Laura Landon, Grafton, NE

#525 **Laura Landon Basket, Signed Novel, Books on Tape, Mug, Cocoa**  
Laura Landon, Grafton, NE

#526 **Gourmet Foods – Pickled Asparagus**  
Ely Farms, Grafton, NE

#527 **Fall Welcome Box**  
The Country Pumpkin, Sutton, NE

#528 **John Deere Scene Puzzle in Barnwood Frame**  
Elizabeth Hofmann, Sutton, NE

#529 **Medallion Plate with Iron Stand**  
Elizabeth Hofmann, Sutton, NE

#530 **2 Royal Copley & 2 Lugenex Collector Chickens**  
Sutton Volunteer Group, Sutton, NE

#531 **Poster by Renar; Print by Gustave Caillebotte**  
Sutton Volunteer Group, Sutton, NE

#532 **12"x16" Winter Scene Print**  
Jeri Rippe, Bruning, NE

#533 **16"x20" Winter Scene Print**  
Jeri Rippe, Bruning, NE

#534 **"Welded Horseshoe Cross made by Terry McBride**  
Anonymous

#535 **"Barnwood Bench 3 1/2' x4'**  
Shana Gerberding, Deshler, NE"

#536 **"Searching for Shelter" Bronze Sculpture of Mother Grizzly & Cub**  
The Bronze Horse, Elkhorn, NE

#537 **Barnwood Framed Acrylic Original Buffalo Painting (1 of 6 in series)**  
Blue River Art, Glenvil, NE

#538 **Turquoise & Copper Arrowhead Necklace, "Peek a Boo"**  
Jewelry by Sonell, North Platte, NE

#539 **Award Winning Oil Painting, "Sandhill Splendor"**  
Linda Lacy, Ashby, NE

#540 **Josephine Necklace Sterling Silver & Amazonite 18" Chain**  
Drew Curtright Designs, Lincoln, NE

#541 **Cross Sign Made of Pallets, "With his wounds we are healed."**  
Kristie Wilkins, Bruning, NE

#542 **20"x24" Painting, "Sit a Spell," View of Cattle in a Pasture from the Front Porch**  
Jamie Luttrell, Hebron, NE

#543 **Framed 13"x31" Oil Painting, "The Promontory"**  
Jana Van Housen, Aurora, NE

#544 **Framed 15" x 20" Print of Cowboy & Horse, "The Grass is Belly Deep"**  
David Dorsey, Valentine, NE

#545 **Miniature Saddle "1880's Northern Plains Half Seat" Bronze #2 of 50**  
Linda Egle, Thedford, NE





# Auction

★ SILENT ★

- |  |  |  |
|--|--|--|
| #546 Metal Sculpture interpreting Nebraska Prairie, "Prairie Flowers"<br>Sally Jurgensmier, Minden, NE   | #563 Gas Power Honda Wire Winder with Six Extra Spools<br>Robison Farms, Elk Creek, NE   | #580 Moroccan Oil "Repair" Travel Bag<br>SOS Portable Toilets, Hastings, NE  |
| #547 16"x24" Canvas Print of Nebraska Corncrib/Barn<br>Photography by Kris Rosenow, Elmwood, NE  | #564 22" Recycler Personal Pace Walk Power Too Mower, Trimmer, Ultra Blower, Leaf Collector, Spring Bucket<br>Exmark Manufacturing, Beatrice, NE | #581 Moroccan Oil "Volume" Travel Bag<br>Strands Salon, Hastings, NE   |
| #548 RV Vacation Rental for 7 days & 500 miles<br>Leach Camper Sales, Lincoln, NE  | #565 Husqvarna High Wheel Trimmer<br>Weaver Repair, Inc., Geneva, NE   | #582 Brighton Devotion Jewelry<br>Necklace & Bracele<br>Gary Michael's Clothiers, Hastings, NE                                 |
| #549 1 Night Lodging for 6 w/ Fishing Next Day<br>Rader Lodge, Glen Elder, NE  | #566 Wood Baby Cradle & Quilt<br>Mike & Ellen Long, Hebron, NE   | #583 Butterfly Tiffany Nightlight<br>Showcase, Hastings, NE  |
| #550 Longhorn Hat Rack<br>Dick & Cheryl Walsh, Hebron, NE  | #567 Wildlife Fire Pit<br>Meyer Metals, Linn, KS   | #584 Granite Cheese Board, Wine Cork Topper & Steak Markers<br>.i AM me, Hastings, NE  |
| #551 Craftsman Wet/Dry Vac<br>Superior Ace Hardware, Superior, NE  | #568 Antique Spear Rendition<br>Tumbleweed Trading Co., Hastings, NE   | #585 Chinese Water color by Jingwei Yao<br>"Mount Rushmore"<br>Lincoln 55+ Seniors Paper, Lincoln, NE                          |
| #552 Summer Bag with Hair Products<br>Cutting Edge Salon, Superior, NE   | #569 Ruko-11 Piece Fish & Game Processing Kit<br>Orscheln Farm & Home, Hastings, NE  | #586 Vintage Carving Set by G. Cowen, Sheffield, England<br>Sutton Volunteer Group, Sutton, NE                                 |
| #553 Gift Basket- Hair Products & Accessories<br>Waves Salon, Superior, NE   | #570 Mychancic-Tool Creeper & Pod Light<br>Orscheln Farm & Home, Hastings, NE  | #587 Night Light & Containter in Basket<br>For All Seasons, Clay Center, NE  |
| #554 Husker Watch, (1 of 2)<br>Lincoln Jewelry, Lincoln, NE  | #571 Concrete Leaf for Home or Garden Display<br>Nature's Impressions, Lawrence, NE  | #588 Purse with Green Bag<br>Carlece Kenner, Hebron, NE  |
| #555 Husker Watch, (1 of 2)<br>Lincoln Jewelry, Lincoln, NE  | #572 Gift Certificate<br>Nebraska Golf & Turf, Lincoln, NE   | #589 Boisset Collection, "Reserve"<br>Private Guide Fine Wine Tasting & Magnum of JCB #21<br>Shelley Bursik Kuzma, Lincoln, NE |
| #556 Red, White & Blue, Gold Bracelets & Ring (1 of 2 Sets)<br>Lincoln Jewelry, Lincoln, NE  | #573 Sterling Silver Earrings with Box Chain & Pendent<br>Helzberg Diamonds, Lincoln, NE   | #590 Boisset Collection Case of "Custom Label"<br>Create your own Label<br>Shelley Bursik Kuzma, Lincoln, NE                   |
| #557 Red, White & Blue, Gold Bracelets & Ring (1 of 2 Sets)<br>Lincoln Jewelry, Lincoln, NE  | #574 Wall Mounted Wine Rack with Shelves & Decorative Tin, Wine & Liqour Shelf<br>Anonymous Donor  | #591 Stafix Unigizer 20 MI Fencer & Fence Alert<br>Geneva Milling Co., Geneva, NE  |
| #558 "Frost" Basket, Variety of Nebraska Gear<br>Southfork Farms - Jason & Blair Pribyl, Milligan, NE  | #575 Wreath, "God Bless America"<br>Perfectly Twisted, Geneva, NE  | #592 Scene on Handsaw<br>The Saw Lady, Chester, NE   |
| #559 Cow Painting on Wall Hanger<br>Johnson Pharmacy, Friend, NE   | #576 Wood 2 Drawer File Cabinet<br>Barber Home Furnishings, Fairbury, NE   | #593 Hand Painted Gourd w/ Embellishments<br>"Faith & Freedom"<br>Reineke Design Studio, Lincoln, NE                           |
| #560 4 Handmade Copper Mugs<br>Handlebend LLC, O'Neill, NE   | #577 MS261 C-M18 Stihl 18" Chainsaw<br>Scherbarth Ace Hardware, Fairbury, NE   |  |
| #561 B&W Turnover-ball Goose-neck Hitch<br>Spring Creek Repair, Dorchester, NE   | #578 Booster Pack Jumpstarter<br>Action Auto Supply, Fairbury, NE  |  |
| #562 Hand forged Hunting Knife based on Scandinavian Puukko design, Osage Orange 80+yr fence post handle & presentation box Century old barn siding from Nebraska<br>Bullhead Blacksmith Shop, Deshler, NE | #579 Air Compressor<br>North Central Air, Down, KS   |  |

**BRAIN CANCER**

Honoring Those Affected | 25





# 

- #594 **Montezuma 36" Black Portable Tool Box**  
John Greer, Edgar, NE
- #595 **Inspirational Sign – Custom Made**  
All Things Consignment Shop, Geneva, NE
- #596 **Original Pencil Hereford Bull Drawing, 10x14", 10 Limited Edition Prints**  
Amanda Raithel, Falls City, NE
- #597 **Cowhide Purse w/ small Accessory Bag & Koozie**  
Divas Floral Shop & Boutique, Kearney, NE
- #598 **Wood Sign with Calf & Wood "Family" Sign**  
Red Barn Creations, Milbank, SD
- #599 **Chloe & Lex Tote Bag Genuine Cowhide Purse**  
Bow & Arrow Boutique, Kearney, NE
- #600 **Wilton Armetale Chip & Dip Cowboy Hat**  
A Little Inspiration, Geneva, NE
- #601 **Blink Outdoor Security Cameras**  
North Pointe Insurance Inc., Geneva, NE
- #602 **Cattlemen's Ball 2018 Sign**  
Heartland Bank, Geneva, NE
- #603 **2 Bottles of Lazy Horse Wine & 2 Tickets to Wade Bowen & Stoney LaRue July 12th in Geneva**  
Wadell & Reed, Geneva, NE
- #604 **Basket of Locally Made Items**  
Mumm Hay Service, Geneva, NE
- #605 **Basket of Pampered Chef Items**  
Heather Mumm, Geneva, NE
- #606 **Davy Crockett Green Mountain Grill & Bag of Pellets**  
Farmers & Merchants Bank, Milligan, NE

- #607 **Daniel Boone Green Mountain Grill, Pellets & Seasonings**  
Sapp Bros, Omaha, NE
- #608 **16" Burlap Wreath**  
Carm Hinrichs, Bruning, NE
- #609 **Box of Ribeyes**  
McLean Beef, Stromsburg, NE
- #610 **2- Nebraska Designed Shirts**  
Wanda Moses, Fairmont, NE
- #611 **Gift Cert for Dozen Cinnamon Rolls**  
Foote Café, Chester, NE
- #612 **Wooden Sign – "A Farmers Prayer"**  
Stoddard Sign Co., Chester, NE
- #613 **Canvas Art – 2 Cows**  
The Feathered Nest, Belleville, KS
- #614 **Gift Cert for 12 "x 34" x 3 1/2" Custom Limestone Name Rock**  
Fisher Rocks, Belleville, KS
- #615 **8" x 10 3/2" Whip Cancer Logo Rock**  
Fisher Rocks, Belleville, KS
- #616 **12" x 12 x 3 1/2" Cattlemen's Ball Logo**  
Fisher Rocks, Belleville, KS
- #617 **Collection of 4 – 2'x2' Barn Quilts**  
LRS Consulting, Chester, NE
- #618 **2'x2' Barn Quilt**  
LRS Consulting, Chester, NE
- #619 **4'x4' Barn Quilt**  
LRS Consulting, Chester, NE
- #620 **5' Cross Cut Saw with Nebraska Scene**  
Nutsch, Inc., Chester, NE
- #621 **Wooden Airplane on Display Stand**  
Carole Sutton, Chester, NE
- #622 **Gift Basket from Good Intentions Boutique**  
Wenske Repair, Bryron, NE
- #623 **Danger Gift Basket with 4 Season Tickets**  
Bosselman Ent, Grand Island, NE
- #624 **Antique Oak Washstand with China Pitcher & Bowl**  
Mike & Rhonda Starbuck, Hebron, NE
- #625 **"In the Shade" Oil Painting by Trayer**  
Metro Gallery, Lincoln, NE

- #626 **Wine & In House Gifts**  
The Pour House, Friend, NE
- #627 **"Ready to Dine" Walnut Hand Carved Bull, Salad Bowl, Cloth Napkins & Rings**  
Sutton Volunteer Group, Sutton, NE
- #628 **18" x 30" Pastel Painting "East of Hebron" part of Cattlemen's Ball Series #4**  
Robert Borzekofski, Beatrice, NE
- #629 **"Spring Time Trees" 18x24" Abstract Acrylic**  
Kris Miller, Scottsdale, AZ
- #630 **"Fresh Air" 16"x20" Abstract on Panel Board Dark Frame**  
Kris Miller, Scottsdale, AZ
- #631 **"Sunset" 12x36" Acrylic on Canvas w/ Gold Frame**  
Kris Miller, Scottsdale, AZ
- #632 **8mm Round Stone Turquoise Earrings**  
KVK Jewelry Design, Henderson, NE
- #633 **Barn Quilt - "Railroad Crossing" - 40"x40"**  
Straight Farms, Shickley, NE
- #634 **Plants in an Iron Planter**  
The Petal Patch, Hardy, NE
- #635 **Large Bowie Style Knife**  
Steel Pig Forge, Lincoln, NE
- #636 **Wagon / Gift Basket of Deshler Items**  
Deshler Chamber of Commerce, Deshler, NE
- #637 **Autumn Blaze Maple Tree**  
Plains Tree Farm, Davenport, NE
- #638 **Family Pack, 4 Admission Passes**  
Vala's Pumpkin Patch, Gretna, NE
- #639 **Wood Plank Wall Art**  
Jill Baker, Hebron, NE
- #640 **Handmade Leather & Bead Bracelet**  
Jill Baker, Hebron, NE
- #641 **Western Embelishments**  
Jill Baker, Hebron, NE
- #642 **Signature Homestyles Horse Print**  
Rachelle Jarchow, Deshler, NE
- #643 **Horseshoe Amazing Grace Cross**  
Jarchow Creations, Deshler, NE
- #644 **Gift Basket**  
Steeple Brewing Co., Hastings, NE





# ★ SILENT ★ Auction

- |      |   |      |   |      |   |
|------|---|------|---|------|---|
| #645 | <b>2x Knitted/ Croched Kids Hats</b><br>Marigold + Rose, Holdrege, NE                               | #664 | <b>Quilt &amp; Pillow-made with shirts from All the Years of RFL in Thayer County</b><br>Relay For Life Committee                                 | #678 | <b>Lap-Size Quilt</b><br>Sew Bee It Quilt Shop, Hebron, NE  |
| #646 | <b>Union Pacific Sweatshirt</b><br>Spring Creek Model Trains, Deshler, NE                           | #665 | <b>2 Days Unlimited Golf with Carts</b><br><i>Includes Meals for 4 People</i><br>Dismal River Club, Mullen, NE                                    | #679 | <b>Canvas</b><br>Amy's Expressions, Hubbell, NE   |
| #647 | <b>Solar Power Extension Cord</b><br>Deshler Electric, Deshler, NE                                  | #666 | <b>"Baseball Basket" - Cabelas Chair, Cooler &amp; Essentials</b><br>Home & Country LLC & Drake Refrigeration, Heating, Cooling & Appliance       | #680 | <b>"Wine Gift Basket</b><br>The Bottle Shop, Hebron, NE   |
| #648 | <b>Lipsense Lipstick &amp; Gloss</b><br>Snip N Clip, Byron, NE                                      | #667 | <b>Boot Jack, Headstall, Medicine Saddle Bags, Tripping Breast Collar, Roping Breast Collar</b><br>Bruning Saddle Shop, Bruce Bruning, Pueblo, CO | #681 | <b>Gold Vase with Make-up Case &amp; LipSense Starter Kit</b><br>Grin & Wear It, Hebron, NE         |
| #649 | <b>"Be Kind" Board Sign</b><br>Snip N Clip, Byron, NE   | #668 | <b>Vase with Flowers, Lantern, Windmill &amp; Arrows</b><br>Seward Academy, Seward, NE  | #682 | <b>Large Norwex Mop &amp; Rubber Brush, Gift Card</b><br>Tami Logsdon - Norwex, Hebron, NE          |
| #650 | <b>Court Tile Signed by Tim Miles</b><br>University of Nebraska-Lincoln                             | #669 | <b>Western Framed Art 15"x18"</b><br>Sunset photo with LED lights & Scripture<br>You've Been Framed, Byron, NE                                    | #683 | <b>Gift Basket with Wine Glasses, Decorative Signs &amp; Shirts</b><br>2 Mom's Designs, Hebron, NE  |
| #651 | <b>Baseball Signed by Coach Darin Erstad</b><br>University of Nebraska-Lincoln                      | #670 | <b>"16x20" Framed Canvas Print taken along the Little Blue River</b><br>Joy Philippi, Bruning, NE   | #684 | <b>"16x20" Canvas Print of a Buffalo</b><br>Annette (VanBuren) Leu, Waterbury, NE                   |
| #652 | <b>Mini Basketball Signed by Coach Amy Williams</b><br>University of Nebraska-Lincoln               | #671 | <b>Rodan &amp; Fields Spring Renewal Gift Set</b><br>Jenny McCord, Superior, NE   | #685 | <b>Tall Vase Glass with Beads &amp; Dry Floral Arrangement</b><br>Friends at the Niche, Sutton, NE  |
| #653 | <b>"Dream Like a Champion" Book Signed by Coach John Cook</b><br>University of Nebraska-Lincoln     | #672 | <b>Traeger Pro Series 34 Grill</b><br>C & M Supply, Ruskin, NE  | #686 | <b>Rustic Metal Tin with Mint &amp; Birdstake "Blessings"</b><br>Remco, Inc., Sutton, NE            |
| #654 | <b>Fashion Shaw &amp; Scarf Combo</b><br>One Classy Hooker, Lincoln, NE                             | #673 | <b>Weber Spirit II LP Gas Grill - Red</b><br>Sack Lumber, Hebron, NE  | #687 | <b>Farmhouse Tin Planter with Windmill</b><br>The Petal Pusher, Henderson, NE                       |
| #655 | <b>Hand Drawn "Farmhouse" Sign</b><br>2 Mama's Joys, Cuba, KS                                       | #674 | <b>Leather Stamped Purse with Fur</b><br>Joe Kierl, Guide Rock, NE  | #688 | <b>Metal Horseshoe Cross</b><br>Bob Sass Flowers, Hastings, NE                                      |
| #656 | <b>OGIO Travel Bag with Free Embroidery</b><br>Hebron Sports Shack, Hebron, NE                      | #675 | <b>Blacksmithed Steak Turner</b><br>Cooper Kremer, Aurora, NE   | #689 | <b>Twin M Coozie, Wyoming Wool Lined Leather</b><br>Wynk Boutique, Hastings, NE                     |
| #657 | <b>Backhoe Playground Toy</b><br>81 Trailer Sales<br>Randy & Cheryl Hissong, Hebron, NE             | #676 | <b>Framed Tree Picture</b><br>Priefert Pharmacy, Hebron, NE   | #690 | <b>Gift Certificate, Name Cardholder &amp; Phone Holder</b><br>Eakes Office Solutions, Hastings, NE |
| #658 | <b>Teeter Totter</b><br>81 Trailer Sales<br>Randy & Cheryl Hissong, Hebron, NE                      | #677 | <b>"Let us Run with Perseverance" Horse Picture</b><br>Priefert Pharmacy, Hebron, NE  |      |   |
| #659 | <b>Surface Hair Care Basket</b><br>Essence Hair Studio, Hebron, NE                                  |      |   |      |   |
| #660 | <b>Gift Basket</b><br>Daylight Donuts, Hebron, NE   |      |   |      |   |
| #661 | <b>Beach Bag Gift Set</b><br>Bless Your Closet Boutique, Hebron, NE                                 |      |   |      |   |
| #662 | <b>4- \$25 Gift Cards, 5-Free Single Topping Pizza Coupons</b><br>Casey's General Store, Hebron, NE |      |   |      |   |
| #663 | <b>Folding Wagon</b><br>Thayer County Daycares  |      |   |      |   |

**BRAIN CANCER**

Honoring Those Affected | 27





# 

- |   |   |  |
|---|---|--|
| #691 Tap Room Tasting & Tour for 8<br>First Street Brewing, Co, Hastings, NE                                | #704 Custom Engraved Henry Golden Boy<br>22 cal. Rifle, Serial No. 10<br>Sponsored by Petersen LP Gas                                   | #714 2 West Stadium Club Seats<br>Sept 29th K-State vs Texas Football Game<br>w/Autographed Football<br>Western National Bank, Chester, NE |
| #692 Branded, Pallet Bench & Table<br>Fairbury Livestock, Fairbury, NE                                      | #705 Custom Engraved Henry Golden Boy<br>22 cal. Rifle, Serial No. 11<br>Sponsored by Dick Walsh – State Farm                           | #715 1970's Husker Football Memorabilia<br>Eric & Linda Nutsch, Chester, NE  |
| #693 Aviation Basket<br>Carole Sutton, Chester, NE  | #706 Custom Engraved Henry Golden Boy<br>22 cal. Rifle, Serial No. 12<br>Sp. by Ken & Pam Degenhardt<br>In Memory of Mark Degenhardt    | #716 1995-1997 Husker Football Memorabilia<br>Eric & Linda Nutsch, Chester, NE   |
| #694 Rosen Copper Coated Statue "3 Cowboys<br>on Horseback"<br>Williams Drilling Co., Inc., Belvidere, NE   | #707 Custom Engraved Henry Golden Boy<br>22 cal. Rifle, Serial No. 13<br>Sponsored by Degenhardt Farms                                  | #717 1974 The Univ of NE Cornhusker<br>Decanter, Guide Books<br>Eric & Linda Nutsch, Chester, NE   |
| #695 Rosen Copper Coated Statue "3 Horses<br>Grazing"<br>Williams Drilling Co., Inc., Belvidere, NE         | #708 Custom Engraved Henry Golden Boy<br>22 cal. Rifle, Serial No. 14<br>Sp. by New Frontier Ins.<br>In Memory of Larry Dankenbring     | #718 Husker Hoodie Basket<br>Eric & Linda Nutsch, Chester, NE  |
| #696 Rosen Copper Coated Statue "Indian on<br>Horseback"<br>Williams Drilling Co., Inc., Belvidere, NE      | #709 Custom Engraved Henry Golden Boy<br>22 cal. Rifle, Serial No. 15<br>Sp. by Blue Valley Door<br>In Memory of Jeni Parde             | #719 Husker Party Basket<br>Eric & Linda Nutsch, Chester, NE   |
| #697 Rosen Copper Coated Statue "Saddle<br>Bronc Rider"<br>Williams Drilling Co., Inc., Belvidere, NE       | #710 Custom Engraved Henry Golden Boy<br>22 cal. Rifle, Serial No. 18<br>Sponsored by Chris & Tara Huber                                | #720 Husker Misc Basket<br>Eric & Linda Nutsch, Chester, NE  |
| #698 Rosen Copper Coated Statue<br>"Flying Eagle"<br>Williams Drilling Co., Inc., Belvidere, NE             | #711 Custom Engraved Henry Golden Boy<br>22 cal. Rifle, Serial No. 19<br>Sp. by Lathan & Stacey McLaughlin<br>In Honor of Charlie Kelly | #721 Limestone Rock with painted<br>John Deere Farm<br>Scene & 4 JD Nostalgic Mugs<br>Eric & Linda Nutsch, Chester, NE                     |
| #699 Rosen Copper Coated Statue<br>"Eagle with American Flag"<br>Williams Drilling Co., Inc., Belvidere, NE | #712 Custom Engraved Henry Golden Boy<br>22 cal. Rifle, Serial No. 20<br>Sponsored by Alexander Motors, Co.                             | #722 Limestone Rock with painted Blue Birds<br>Eric & Linda Nutsch, Chester, NE  |
| #700 Rosen Copper Coated Statue<br>"Longhorn Steer"<br>Williams Drilling Co., Inc., Belvidere, NE           | #713 Custom Engraved Henry Golden Boy<br>22 cal. Rifle, Serial No 21<br>Sponsored by Lance Fiala<br>In Memory of Larry Fiala            | #723 Limestone Rock with painted Windmill<br>Eric & Linda Nutsch, Chester, NE  |
| #701 Basket of Scentsy Products<br>Jenelle Bohling, Byron, NE   |   | #724 NE History Books with mini NE<br>State Capitol Stein<br>Eric & Linda Nutsch, Chester, NE  |
| #702 Basket of Crown Royal Products<br>Tillie's Bar & Grill, Byron, NE                                      |   | #725 Pioneer Belt Buckle<br>Rose Brettman<br>In Memory of Willis Brettmann   |
| #703 Custom Cowboy Scene – Saw Art<br>The Saw Lady-Cindy Chinn, Chester, NE                                 |   | #726 Pink Geranium Print "Trust in The Lord"<br>11"x14" & Display Easel<br>Karla Deepe, Deshler, NE  |





# Auction

★ SILENT ★

#727 "Custom Handmade Tote Bag designed for 2018 Cattlemen's Ball  
Karla Deepe, Deshler, NE

#728 "40" x 40" Barn Quilt – Colors of Earth Brown, Cactus Flower and Buffalo Grass  
Karla Deepe, Deshler, NE

#729 Queen Size Quilt  
Sew Country, Belleville, NE

#730 Magnum Bottle of the 2018 Cattlemen's Ball Etched "The Sheriff" Collectors' Edition Wine  
Shelley Bursik Kuzma, Lincoln, NE

#731 Husker Bag of Nebraska Items  
Weaver Pharmacy, Geneva, NE

#732 Crockpot 5 in 1 Multi-Cooker & Kitchen Utensils  
Friend Freight Ways, Inc., Friend, NE

#733 LipSense – 4 Colors & Gloss  
Lorri Milton, Friend, NE

#734 Basket of Bracelets- Rustic Colors  
Lorri Milton, Friend, NE

#735 Gold Necklace with Bracelet  
Wayne & Lorri Milton, Friend, NE

#736 Black & White Necklace, 3 Bracelets  
Wayne & Lorri Milton, Friend, NE

#737 Blackstone Necklace & 3 Bracelets  
Wayne & Lorri Milton, Friend, NE

#738 Stone with Stainless Steel Wire Necklace & Bracelets  
Wayne & Lorri Milton, Friend, NE

#739 "All Across Nebraska" Cookbook  
Virginia Brase, Davenport, NE

#740 "All Across Nebraska" Cookbook  
Virginia Brase, Davenport, NE

#741 "All Across Nebraska" Cookbook  
Virginia Brase, Davenport, NE

#742 "30" x 30" Black Metal Heart "Tree of Life"  
Muddy Water Design/Sugar Shack, Edgar, NE

#743 "3' x 2' "Faith Can Move Mountains" Metal Sign  
Muddy Water Design/Sugar Shack, Edgar, NE

#744 "Longhorn Skull with 60" Wide Spread  
Koch Cattle Company/Tim Koch, Daykin, NE

#745 "16" x 20" Canvas photo "Fall in the Country"  
Nye Street Studio, Omaha, NE

#746 "Tupperware Package  
Vicki Alber, Blue Hill, NE

#747 "Watercolor- "Scottsbluff, NE Landscape"  
Deon Smalley, Salina, KS

#748 "Black & White Photo of Calves w/ Barnwood Frame  
Elysabeth Kierl, Guide Rock, NE

#749 "Covered Wagon & 2 Horses Handcrafted using laths from Lake Mansion  
Hintz Cheese, Crafts & Balloons, Hebron, NE"

#750 "4 x 4 Barn Quilt with Black Bull  
Nikki Drohman, Ruskin, NE

#751 "4 x 4 Barn Quilt, Colors: Black, Orange, Yellow & Red called "Awakening"  
Seward County Barn Quilters

#752 "John Deere Barn Quilt  
Krissy Ozenbaugh, Ohio, NE

#753 "Case I-H Barn Quilt  
Krissy Ozenbaugh, Ohio, NE

#754 "Battle Flag"  
Winkel Mfg Co., Inc., Glen Elder, KS

#755 "Cow Calf Foot Scraper  
Winkel Mfg Co., Inc., Glen Elder, KS

#756 "Toys: Cattle Chute, Feeder, Hay Bales. 4 piece Panel Set, Bull, Cow & Calf  
Kohmetscher Feed Store, Red Cloud, NE

#757 Framed "Western" Picture  
Ron Huss, Lincoln, NE

#758 "What's on the Menu?" Gift Cards to Local Establishments  
Charlie's Pub, Milligan. Hwy 41 Express, Milligan. Friend Country Club  
Friend. MaMa D's, Western

#759 3' x 4' Picture, Ribbon Carved out of Wood in Black with Stained Wood  
Colby Hergott, Bruning, NE

#760 Gun Safe Pickup Toolbox  
Moeller Electric, Inc. Byron, NE

#761 Santa Trio Set  
Jerry Harrenstein- for Sue, Lincoln, NE

#762 Larimar & Sterling Silver Necklace & Earrings  
Jack & Margaret Barbeau, Celina, TX

#763 Basket of Items, "Keep Cool"  
Kenesaw Motors, Kenesaw, NE

#764 Polished Serving Dishes, Chasing Horse Collection  
Sutton Vet Clinic, Sutton, NE

#765 Signed Jersey  
Rex Burkhead

#766 4- Tickets to Royals Game & One Night Hotel Stay  
Greg & Julie Else, Overland Park, KS

## BRAIN CANCER

Honoring Those Affected | 29







## TRACY LAWRENCE

— FRIDAY, JUNE 1, 8:30 PM —

As one of the most recognizable voices in country music history, it's only appropriate that a man whose career was launched on a radio show, "Live at Libby's," returns to the studio for his own show. Tracy Lawrence is bringing his new syndicated radio show, Honky Tonkin' with Tracy Lawrence, to the "Air Castle of the South."

Honky Tonkin' with Tracy Lawrence debuted at noon CDT Sunday, August 16 on Nashville's legendary traditional country music outlet, WSM-AM. The three-hour show, produced by Silverfish and syndicated through Compass Media Networks, features hits from the 1980s, '90s and early 2000s, interviews and special guests, contests, prizes and audience interaction through calls and social media. Guests of the show have previously included Reba McEntire, John Anderson, and more.

# A Conversation With... LUCAS HOGE

Country Superstar talks about growing up in Nebraska and coming home for Cattlemen's Ball

**Q:** What was it like growing up in Hubbell?

**A:** "I think growing up in a small town, it puts a great work ethic in you. You grow up figuring out how to do things on your own and you grow up around great people."

**Q:** Anything you want to tell fans about Cattlemen's Ball, June 1-2?

**A:** "Everybody come out, have a great time for a great cause and I look forward to seeing everyone again. I can't thank everyone enough for all the support over the years, I couldn't have done it without them."



The new album from Lucas Hoge, "Dirty South" is out now.





# TRACE ADKINS

— SATURDAY, JUNE 2, 8:25 PM —

**SPONSORED BY ★ GLENN KORFF FOUNDATION**

A Nashville icon for more than two decades, Trace Adkins has made his mark on the country-music industry. 11 million albums sold. Time-honored hit singles. Momentous, fiery and always memorable live performances. Grammy nominations. Even a slew of movie and TV roles have come the Grand Ole Opry member's way. Ask Adkins what's left to prove in his career and the small-town Louisiana native says it's simple: To continually feel the excitement that comes after whipping up a new song out of thin air and laying it down to tape. "It's an adrenaline rush and I love it," says Adkins, who spent much of last year in a Nashville studio writing and recording with some of Nashville's most respected songwriters including Shane McNally, Tyler Farr and Craig Campbell. The result was *Something's Going On*, his 12th studio album and his first release on his new label, BBR Music Group/Wheelhouse Records.



The perfect harmony between today's modern country hits and yesterday's country classics, Forgotten Highway prides itself on being able to successfully walk the line between the two worlds. Combining the guitar sounds of the 1950s and integrating them with modern country and acoustic instruments has given Forgotten Highway one of the most unique country voices on the music scene today. Teaming up with some of the youngest and most talented musicians in the midwest has allowed front men Hunter and Andrew the opportunity to create and refine a sound that is as unique as anything that comes out of Nashville today. After touring for only 2 years, performing at Country on the River and playing on main stages of church festivals and Fourth of July parties seemed to be the pinnacle of their success. But Forgotten Highway has made it clear that they are not at all done, as they opened for Phil Vassar, The Swon Brothers, Chris Cagle, and Sawyer Brown over the course of their 2014 tour season. Additionally, they have been selected to open for Country Superstars Joe Nichols, .38 Special, Gary Allan, Sawyer Brown, & Little Texas in 2015. Forgotten Highway is a name you won't forget.



# RANCH RODEO

— SATURDAY, JUNE 2, 2018, 1:45 PM TO 3:30 PM —



## SPONSORED BY TOBE ★ ROBYN DUENSING FAMILY

### PREMIUM FEEDERS INC, SCANDIA KS

- James Callahan
- Robert Wright
- Josh Cornet
- Tyler Hall

### HANGIN H RANCH, PAXTON NE

- CJ Pankonin
- Darren Sellers
- Taylor Hendricks
- Greg Eshelman

### NO LAND ★ CATTLE, OHIOWA NE

- Chris Weber
- Curtis Thomas
- Alex Fehringer
- Brent Hall

## TEAMS

### MOREHEAD TEAM, CLYDE KS

- Larry Morehead
- Rusty Moorehead
- Cole Morrehead
- Travis Merritts

### TRES ESTADOS VAQUEROS TEAM, BYRON NE

- Trey Duensing
- Clay Hill
- Wes Schou
- Mike Flanigan

### MEYER POLLED HEREFORD, HEBRON NE

*Team Members are from North Platte*

- Brett Gartrell
- Buster Gartrell
- TJ Williams
- Lee White



**ANNOUNCER: ETHAN SCHUETTE, WASHINGTON, KS**

**BELT BUCKLE SPONSOR: NEAL HANSEN, PARADISE VALLEY, AZ**

32 | Entertainment



# SURVIVOR STYLE SHOW

— SATURDAY, JUNE 2, 2018, 2:30 PM TO 4:00 PM —

"You are braver than you believe

**STRONGER** *than you seem*

**A SMARTER** *than you think*

**AND BEAUTIFUL"** *twice as*

**SPONSORED BY**

**FRANK ★ MARY BRUNING**

## Master of Ceremonies: Ashli Brehm

The 2018 Style Show is one of the main highlights of this year's Cattlemen's Ball. This year, the show features men, women, and children who have braved the tough battle of cancer head on and today, brave the runway to share with us their journey and win over cancer. Our cancer fighters and survivors come from across the state, with many coming from our surrounding local communities. What an inspiration each model that walks the runway today is for each of us as we have all been touched by cancer in some way. We truly thank all of our models today for sharing their courageous battle with us and braving the runway. We also want to thank all of the stores and boutiques that helped clothe all of the models today. Remember, "life is not about waiting for the storm to pass, it's about learning to dance in the rain."

Enjoy the show!

## ~2018 Style Show Committee

## CLOTHING SUPPLIED BY

Kirtsey's: York, NE

Mylah Rose: Geneva, NE

Sapphire Boutique: Friend, NE

Stella Collective: Lincoln, NE

Western Edge: York, NE

Wynk: Hastings, NE

Hebron Sport Shack: Hebron, NE

Allure Fashions: Seward, NE

Ash & Ash: Lincoln, NE

Bless Your Closet: Hebron, NE

Bow and Arrow Boutique: Kearney, NE

Cumberlands: Geneva, NE

Edge: Lincoln, NE

Good Intentions: Byron, NE



## PROSTATE CANCER

Honoring Those Affected | 33



# GOLF OUTING

— FRIDAY, JUNE 1, 2018, 8:30 AM —

**SPONSORED BY**



**— HEBRON COUNTRY CLUB —**



**Trophy Sponsor:**  
StoneBrook Exteriors

**Hole-In-One Sponsor:**  
Car Carriage Motors

**Hole-In- One \$5,000 and Prizes:**  
Power Consulting Associates

**Lunch Provided by:**  
Arends Family Foods  
Bruning Grocery

## **Hole Sponsors:**

Blue Valley Bowl  
Posey Real Estate  
Ron & Michelle Dubbert  
Mussman Excavating  
Progressive Chiropractic  
Wenske Automotive  
Krupicka Farms  
ARC Group - Heather Ramsey  
Germer, Murray & Johnson

## **Flag Hole Prizes Sponsor:**

Pohlmeier Ag Chem - Pioneer  
RTM Farms - Pioneer  
Tall Pine Ag - Pioneer  
Asgrow/Dekalb  
Farm Bureau Financial Services  
— Kendall Schlake





# RAWHIDE RUN

— SATURDAY 6:00 AM CHECK-IN | STASTNY CENTER | 13TH ★ DOVE ROAD | HEBRON —

BROUGHT TO YOU BY:



Why do people run? Sometimes they run for swag. Sometimes they run for the pure joy of feeling the ground beneath their feet and the wind in their face. Sometimes they run for even better reasons, like to battle cancer.

The first-ever Rawhide Run is sponsored by Brodstone Memorial Hospital of Superior, Nebr. and is the first run connected to the Cattlemen's Ball of Nebraska. Entrants run through one of the most picturesque places in southeastern Nebraska, down the tree-lined road that follows the Little Blue River. With a paid ticket, runners are also invited to join in all of the activities of the Cattlemen's Ball on Saturday.

To make it even more special, runners are turning the traditional running bibs backwards for this special event. Instead of a number, they will write the name of a friend or family member who has battled or is currently battling cancer on their bib. The bibs will be displayed outside one of the main tents on the grounds of the Cattlemen's Ball event. Stop by to see the names of family and friends these runners are paying tribute to. Together we can Whip Cancer



PROSTATE CANCER

Honoring Those Affected | 35





# ACTIVITIES

## OPENING CEREMONIES

SATURDAY, 1:00 PM

SPONSORED BY



METALQUEST

## AIR SHOW

SATURDAY, 1:15-1:45 PM



## BLACKSMITH DEMONSTRATIONS



SPONSORED BY  
JOHN MUSGRAVE

## HELICOPTER RIDES

FRIDAY, 1:00 PM-4:00 PM • SATURDAY, 8:00 AM-4:00 PM

## ANTIQUE TRACTOR DISPLAY



## RotorWings Aviation



was the way to go. Seizing the opportunity provided by the Hebron Airport Authority, RWA expanded and now offers more services to support the area. Kevin brings with him more than twelve years owning/operating and maintaining both military and civilian aircraft. From the little Cessna 150K that he learned to fly in, to the Special Operations Blackhawks he maintained, his vast experiences and knowledge allows him to be the regions "go-to guy" for all aviation operations.

RotorWings Aviation, LLC, often referred to as "RWA", was founded by Thayer Central graduate Kevin Mitchell in 2015, as a way to provide contract pilot services and flight instruction. After a year of traveling the country, Kevin decided that basing the company out of the Hebron Airport

At RWA, safety is of the utmost importance. During his nine years of active duty service, Kevin learned the only successful mission is one where everyone goes home at night. Our pilots are highly qualified, our aircraft and equipment are maintained to the highest standards, and everyone shares the safety mindset.





Local  
Network.  
State-wide  
Reach.

*One source*

**FLOOD**  
COMMUNICATIONS

**nch** **SPORTSNOW**

**nch** NEWS CHANNEL  
**NEBRASKA**

**orRed**  
99.5

**KWB**  
1450 AM • 94.7 FM

**KGMT**  
"GOOD TIME OLDIES"  
1310 AM

**B 103**  
Today's Best Country!

**OTOE COUNTY  
COUNTRY**  
105.5 FM - 1600 AM  
Old. As. Dirt.

**NORFOLK**  
**US92**  
Today's Best  
Country!

**THE NEW  
94 ROCK**

**LOBO**  
97.7 FM

**TELEMUNDO  
NEBRASKA**





# 2018 CATTLEMEN'S BALL TRUCK RAFFLE SPONSORED BY:

**WOODHOUSE** WOODHOUSE  
AUTO FAMILY

**SATURDAY, JUNE 2, 2018, 7:00 PM**



**'18 FORD F\*150**



**'18 DODGE RAM 1500**



**'18 CHEVY SILVERADO 1500**

**\$100/TICKET**

**TRUCK  
OF YOUR  
CHOICE!**

Winner does not need to be present to win. All proceeds go to the Cattlemen's Ball of Nebraska, Inc., an annual fundraiser for the Fred & Pamela Buffett Cancer Center for cancer research. Winning ticket holder must notify the Raffle Ticket Committee no later than June 11, 2018. Contact Deb Hansen at 402-529-6369. There is no cash buyout. Winner is responsible for taxes and licensing, plus arranging delivery of vehicle. An IRS Government 1099 form will be provided. Cattlemen's Ball of Nebraska, Inc. State ID #35-7793405. The winner to pay the 30% FET (25% federal and 5% state) to the Cattlemen's Ball prior to taking possession of the prize.



**38 | Retail, Raffles & Refreshment**





# We Know Trucks.

See all of our inventory at [woodhouse.com](http://woodhouse.com)



**Woodhouse Chevrolet Buick**  
1951 West Highway 30  
Missouri Valley, IA 51555  
(712) 642-4131

**Woodhouse Ford of Plattsmouth**  
2288 Osage Ranch Blvd  
Plattsmouth, NE 68048  
(402) 296-9000

**Woodhouse Ford of Omaha**  
3633 N. 72nd Street  
Omaha, NE 68134  
(402) 574-2600

**Woodhouse Ford Blair**  
2546 Highway 30  
Blair, NE 68008  
(402) 426-4127

**Woodhouse Buick GMC**  
11911 I Street  
Omaha, NE 68137  
(402) 593-4000

**Woodhouse Place Nissan**  
5312 S 136th Street  
Omaha, NE 68137  
(402) 592-1065

**Woodhouse Nissan Bellevue**  
7801 Nebraska Drive  
Bellevue, NE 68005  
(402) 731-2622



# GENERAL STORE

## HOURS

**FRIDAY, JUNE 1, 2018**  
**4:00 PM TO 7:00 PM**



**SATURDAY, JUNE 2, 2018**  
**9:00 AM TO 4:45 PM**

## VENDORS

You've Been Framed, LLC  
Pine Needle Art/Baskets  
Country Rhoads Jelly  
Dave's Coffee Cakes  
Toy Corrals  
Hickory House Popcorn  
Stray Dog Firearms  
Laura Marie Baxa Designs  
Barb's Buttery Toffee  
Zella Mae Originals  
Diamond Collectibles  
Juice Plus

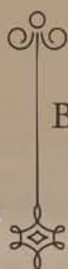

Just Plain Jane  
Clever Container  
Eternal Threads  
The Country Canvas  
Marjorie Mae  
Bow & Arrow Boutique, Inc.  
Jarchow Creations  
Kirtsey's Clothing  
& Gift Boutique  
Larimar Jewelry  
Cumberlands Fashions  
Diller Locker

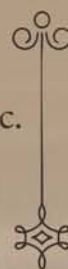

BKV & Whimsy & RY  
Wynk Boutique  
Nebraska Barnwood  
Bruning Saddle Shop  
Mylah Rose Boutique  
Image Skincare  
Turquoise Tractor  
Ash & Ash

## SPONSORED BY



**KNOBEL SEEDS**

*Quality Seed for Every Need*



40 | Retail, Raffles & Refreshment



# CRAFT BREW EXPERIENCE

SATURDAY, JUNE 2, 2018 \* 11:00 AM TO MIDNIGHT

## BREWERY

**Kansas Territory Brewing Company**  
Washington, KS

**First Street Brewing Company**  
Hasting, NE

**Kinkaider Brewing Company**  
Broken Bow, NE

**Lazy Horse Brewing**  
Ohiowa, NE

**Prairie Pride Brewing Company**  
Grand Island, NE

**Scratchtown Brewing Company**  
Ord, NE

**Zipline Brewing Company**  
Lincoln, NE

**Blue Blood Brewing Company**  
Lincoln, NE

**Hanging Horseshoe Brewery**  
Imperial, NE

**Kros Strain Brewing Company**  
La Vista, NE

## BEER LIST

Life Coach Lager  
Summer Breeze\*Shandy

Apricot Blonde  
Thornsberry's Best

Devils Gap Jalapeno Ale  
Herd Law Honey Wheat

Salted Caramel Blonde Ale  
Ranch Hand Blonde Ale

Barn Burn Amber Ale  
Wild Prairie Blonde Ale

Big Joe Pilsner  
MMR Brown Ale

Copper ALT  
Belgian Wheat Mimosa

All Hopped up IPA  
6\*4\*3 Double Play Pilsner

Palomino Pilsner  
Kolsch

Ferry Nectar



*Whip*  
**BREAST CANCER**  
Honoring Those Affected | 41





# ART SHOW

## HOURS

**FRIDAY, JUNE 1, 2018**  
**4:00 PM TO 7:00 PM**



**SATURDAY, JUNE 2, 2018**  
**9:00 AM TO 4:45 PM**

## ART SHOW

### SPONSORED BY

**JERRY ★ JILL CATLETT**



Ashley Spitsnogle, Omaha, NE  
 Paintings & Live Painting  
[ashley.spitsnogle@gmail.com](mailto:ashley.spitsnogle@gmail.com)

Linda Egle, Thedford, NE, Western Sculpture,  
 Western Bronze Sculpture  
[yellowcalfstudio@gmail.com](mailto:yellowcalfstudio@gmail.com)

Jana VanHousen, Aurora, NE, The Renaissance,  
 Oil painting & photography  
[therenaissance@hamilton.net](mailto:therenaissance@hamilton.net)

Jamie Luttrell, Hebron, NE, Hue-niquely  
 Festooned, Painting  
[hayday2@gmail.com](mailto:hayday2@gmail.com)

Drew Curtright, Lincoln, NE, Drew Curtright  
 Designs, Handmade Electro-etched Jewelry  
[drewcurtrightdesigns@outlook.com](mailto:drewcurtrightdesigns@outlook.com)

David Dorsey, Valentine, NE, David Dorsey  
 Western Art, Paintings, prints, drawings  
[daviddeandorsey@hotmail.com](mailto:daviddeandorsey@hotmail.com)

David L. Biehl, Elkhorn, NE  
 The Bronze Horse, Bronze Sculptures  
[dave.hvs50@gmail.com](mailto:dave.hvs50@gmail.com)

Connie Bentjen, Albion, NE, B & PJ Silver, Jewelry -  
 vintage handcrafted  
[rbentjen@gpcom.net](mailto:rbentjen@gpcom.net)

Linda Lacy, Ashby, NE, Calinda's Pot Shop &  
 Gallery, Pottery & Paintings  
[pvaptchart@neb-sandhills.net](mailto:pvaptchart@neb-sandhills.net)

Kerri Votaw Kliever, Henderson, NE,  
 KVK Jewelry Design, Exotic gems & metals  
[kvkdesigns@mainstaycomm.net](mailto:kvkdesigns@mainstaycomm.net)

Cindy Brader, Glenvil, NE, Blue River Art  
 Acrylic/oil watercolor  
[hillblue7@gmail.com](mailto:hillblue7@gmail.com)

Kris Rosenow, Elmwood, NE, Photography by Kris  
 Rosenow, Photographs, Canvas Prints, Cards  
[kris.rosie@gmail.com](mailto:kris.rosie@gmail.com)

Cindy Chinn, Chester, NE, The Saw Lady, Metal Art  
[cindy@cindychinn.com](mailto:cindy@cindychinn.com)

Rob Borzekofski, Beatrice, NE, Pastel Paintings  
[americanheritagelure@tackle@gmail.com](mailto:americanheritagelure@tackle@gmail.com)

Sonja Trenary, Arthur, NE, Jewelry By Sonell, One  
 of a kind Handmade Jewelry  
[smtrenary1941@gmail.com](mailto:smtrenary1941@gmail.com)

Sally Jurgensmier, Heartwell, NE,  
 Sculptures by Sally, Metal sculptures  
[sally@sculpturesbysally.com](mailto:sally@sculpturesbysally.com)

Lynne Reineke, Lincoln, NE,  
 Reineke Design Studio, Gourd Art  
[lynnereineke@aol.com](mailto:lynnereineke@aol.com)

Nia Karmann, Omaha, NE,  
 Nye Street Studio, Photography  
[nyestreetstudio@gmail.com](mailto:nyestreetstudio@gmail.com)

**Cost: 6 Tokens**

**Includes a commemorative  
 Cattlemen's Ball of Nebras-  
 ka glass and 5 tastings.**

**Additional tastings  
 available for 4 tokens.**



42 | Retail, Raffles & Refreshment



# ART SHOW AND WINE TASTING

— SATURDAY, JUNE 2, 2018 AT 10:00 AM —

WINE TASTING

SPONSORED BY  
TIM ★ KAREN ELSE

— VENDORS —

Broken Arrow Cellars  
Lazy Horse Vineyards & Brewing  
James Arthur Vineyards  
Milletta Vista Winery  
Superior Estates Winery  
Boisset Collection Wineries

"Join the Cattlemen's Ball  
Sheriff Society"

For a special donation of  
\$150, you will receive this  
Exclusive 21st Collectors

Edition of our Custom  
Cattlemen's Ball Wine "The  
Sheriff"! Order yours early!

You may pick up bottles  
in advance or at the Cattle-  
men's Ball on June 1st & 2nd  
in the Wine Tasting Tent.  
VERY LIMITED EDI-  
TION. Don't Miss Out!

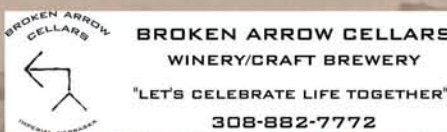

## BREAST CANCER

Honoring Those Affected | 43





# BAR ★ CONCESSIONS

## — BAR OPEN —

Friday, June 1, 2018  
4:00 pm to Midnight

Saturday, June 2, 2018  
11:00 am to Midnight



**BROUGHT TO YOU BY:**  
**Thayer County Bank**

[www.thayercountybank.com](http://www.thayercountybank.com)

### — BEER —

Budweiser  
Bud Light  
Busch Light  
Busch NA  
Bud Light Lime  
Straw Beer Rita  
Miller Light  
Coors Light  
Michelob Ultra  
Mikes Hard Lemonade  
Summer Shandy  
Ruby Red Palm Breeze

### — SPIRITS —

Pendleton  
Crown Royal  
Crown Royal Apple  
Captain Morgan  
Bacardi Rum  
Jack Daniels  
Jim Beam  
Bulleit Bourbon  
Dewars Scotch  
Windsor Canadian  
Tanqueray Gin  
Milagro Tequilla

### — WINE —

Wattle Creek Winery, 2017 Rosé  
Wattle Creek Winery, 2017 White  
Wattle Creek Winery, 2016 Red  
Superior Estates, Twilight  
Lazy Horse Vineyard, Trail Buds



**2018 Signature Cocktail** - Moscow Mule (Vodka), or  
Kentucky Mule (Bourbon) available for purchase in a  
souvenir "Whip Cancer 2018" copper mug.

*Limited quantities of mugs; available in Main Bar and Main Tent Bar.*



# WELCOME



## Thayer County Bank

### Helping To Build A Better Future -

- SBA Lender - Business Transition Financing
- Leader in Community Development
- USDA Business and Industry Lender
- USDA Community Facility Lender
- Affordable Housing Lender for SE Nebraska

**It matters to the community where you bank!**

**EST. 1874**

## THAYER COUNTY BANK

Thayer County Bank is the  
Oldest State Bank in Nebraska  
Family Banking Spanning  
Five Generations



[www.thayercountybank.com](http://www.thayercountybank.com)

P.O. Box 109 / 402 Lincoln Ave.

Hebron, Nebraska 68370

402 768-6027





# BUFFETT

## CENTER TENT

SATURDAY, JUNE 2, 2018, NOON ★ 4:00 PM

### INSIDE THE TENT

- Presentations by graduate students about their cancer research projects at the Fred & Pamela Buffett Cancer Center.
- Dr. Ashley Wysong, new UNMC Dermatology Department Chair with a team of dermatologists, will conduct free facial sun damage assessments, skin cancer screenings and mole checks. Free sunscreen samples and bracelets (that indicate when it is time to re-apply sunscreen) will be distributed.
- "Be The Match" National Bone Marrow Donor Registry Booth



Thayer County Health Services - Hospital and Clinic at Hebron, NE  
Satellite Clinic locations: Bruning, Davenport, Deshler, Chester, and Milligan

Thayer County Health Services will be staffing information centers on colon and breast health. Breast models will be displayed where ball participants can learn how to effectively search for lumps within the breast. Staff will be present to discuss the services they offer for cancer screening, diagnosis, and treatment.



**The cure for blood cancer is in the hands of ordinary people®. You could be the cure. Patients are counting on you.**

Be The Match®, operated by the National Marrow Donor Program® (NMDP), is a nonprofit organization that's dedicated to helping every patient get the life-saving transplant they need. As trusted leaders in advancing treatments for those facing life-threatening blood cancers, we provide the ground-breaking research, innovative technologies, patient support and education that save lives.

If you are between the ages of 18 and 44 patients especially need you. Research shows that cells from younger donors lead to more successful transplants. Doctors request donors in the 18-44 age group more than 95% of the time. If you are between the ages of 45 and 60 and want to join the registry, you're welcome to join online with a \$100 tax-deductible payment to cover the cost to join. [www.bethematch.org](http://www.bethematch.org)

Register between May 15th and June 15th with the code cattlemensball.

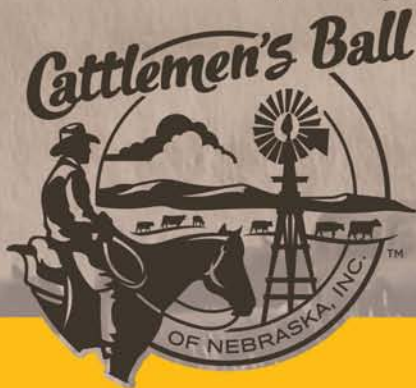

FRED & PAMELA  
**BUFFETT CANCER CENTER**

46 | History, Demonstrations & Displays



The UNMC Nebraska Mobile Simulation Unit 44 foot truck will be onsite next to the Buffett tent. It is staffed by licensed and experienced healthcare professionals and educators for a mobile simulation learning center of an emergency room and an ambulance.



Cargill is proud to be a Platinum Sponsor  
of the 2018 Cattlemen's Ball of Nebraska.

Nebraska Grain Locations

**Albion  
Carleton  
Gibbon**

**Holdrege  
Motola/Minden  
O'Neill**

**Ord  
Shelton  
Wood River**

Cargill - Carleton



**855-796-6926**  
[www.cargillag.com](http://www.cargillag.com)



# WHIPPING UP DECORATIONS



## Table Centerpieces are For Sale!

100% of the price of each table centerpiece will be donated to the Cattlemen's Ball.

Buy one for someone who has cancer or who wanted to come but couldn't.

Buy one as a Christmas gift, or buy one just for yourself!

Centerpieces can be paid for any time on Saturday and can be removed after the Saturday evening meal.



Nancy Hofts of Hebron  
Chairman of Decorations  
AND cancer survivor





# WHIPPING UP DECORATIONS

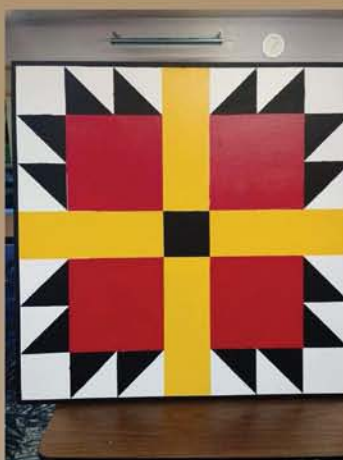
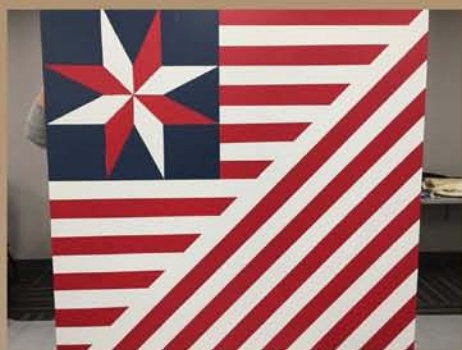

**APPENDIX CANCER**

Honoring Those Affected | 49





# HISTORY TENT

## HOURS

FRIDAY, JUNE 1, 2018  
4:00 PM TO 7:00 PM

SATURDAY, JUNE 2, 2018  
9:00 AM TO 4:45 PM

SPONSORED BY



**GOOD2GO**  
CONVENIENCE STORES  
A Division of **Lichti Oil**

— FEATURING RINKER BUNK —

AUTHOR OF "THE OREGON TRAIL ★ A NEW AMERICAN JOURNEY"

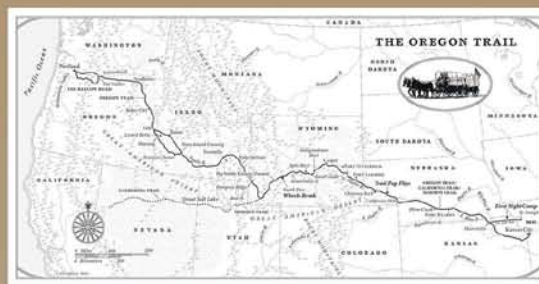
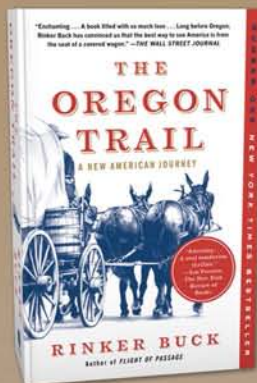

A major bestseller that has been hailed as a "quintessential American story" (Christian Science Monitor), Rinker Buck's *The Oregon Trail* is an epic account of traveling the 2,000-mile length of the Oregon Trail the old-fashioned way—in a covered wagon with a team of mules—that has captivated readers, critics, and booksellers from coast to coast.

— OTHER PRESENTATIONS WILL BE GIVEN THROUGHTOUT THE EVENT BY —

• **Bob Bozell**

Bob is the Associate Director of the Nebraska State Historical Society and will speak about the the archaeology of the Oregon Trail and about artifacts found on the Oregon Trail.

• **Jeff Barnes**

Jeff will present "To Live and Die on the Plains." This will be an interesting look at problems on the trail such as disease, gunshot wounds, stampedes, accidents, Indian attacks and many more!

• **Cherrie Beam Callaway**

Cherrie is a native Nebraska storyteller with the Nebraska Humanities Council. Cherrie will be in character as "Mariah Monahan," an immigrant coming to Nebraska in the mid-19th century.

• **Doug Rung**

Doug is a humanities re-enactor who will speak about life on the Oregon Trail as a Pioneer.

50 | History, Demonstrations & Displays





# HISTORY TENT THE OREGON TRAIL

**SPONSORED BY**



Spanning two thousand miles and traversing six states from Missouri to the Pacific coast, the Oregon Trail is the route that made America. In the fifteen years before the Civil War, some 400,000 pioneers used the trail to emigrate west. Many scholars still regard this as the greatest land migration in history.

The Cattlemen's Ball History tent will focus on the years from 1840 through 1870 in the region of the Blue River Watershed. Early explorations by Stephen Long described the region as "The Great American Desert". John Charles Fremont and Kit Carson began an expedition to the West in this region in 1842 and further helped to map the area. Rock Creek station served many feeder trails between Missouri and Fort Kearney on the Platte Valley. Used by the Pony Express and Stagecoach lines to rest and resupply it was an important stop on the trail. "Wild Bill" Hickok started out working in the stable at Rock Creek Station.

The Kansas-Nebraska Act created the Nebraska Territory in the 1850s allowing for the start of settling the region. Some persons believe a man named Christian Luth, a German, was the first settler in Thayer County. Travelers on the trail made fun of him for trying to farm the "Great American Desert". The first permanent settlers were in the vicinity of Alexandria between the Big Sandy and the Little Blue. Big events during the Civil War provided huge opportunities for the future of the development in the Nebraska Territory. Congress and President Lincoln passed the Homestead Act, Transcontinental Railroad Act, and the Morrill Act in 1862 opening the West to settlers. Cattle Drives also passed North through the Blue Valley toward Schuyler.

New arrivals following the Civil War faced Native Attacks to remove the settlers. Beginning in August of 1864, the Indians made concerted attacks on the stage stations and ranches on the Oregon Trail, hitting nearly every settlement for 400 miles from Colorado to the Big Sandy. More than 100 settlers were killed in the Upper Little Blue River region.

Troops and local militia companies helped to provide protection for settlers after the Civil War. In 1869 Company A, First Nebraska Cavalry, numbering approximately sixty-five members were located at Fort Butler in Thayer County provided protection for early settlers in the Hebron area. Later Fort Kiowa was established 8 miles west and troops from Kearney were stationed there. The establishment of Fort Butler led to the founding of Hebron which becomes the county seat of Thayer County.

The Oregon Trail is this nation's longest graveyard. Nearly one in ten emigrants who set out on the trail did not survive. Main causes of deaths along the Oregon/California Trail from 1841 to 1870 were Disease, Drowning, Accidents, Weather, and Gun Shot Wounds. It has been estimated that 10-15 travelers died each mile of the trail. Of this large number, only a few grave sites remain.

## APPENDIX CANCER

Honoring Those Affected | 51





# BEEF DISPLAY

— SATURDAY, JUNE 2, 2018, 10:00 AM —

SPONSORED BY  
**LONECREEK**  
CATTLE COMPANY

## BEEF DISPLAY EXHIBITORS

Jensen Herefords  
Courtland, KS

Hollman Angus  
Hallam, NE

Mumm Show Cattle  
Belvidere, NE

Mark Hintz  
Hebron, NE

Rains Simmentals  
Dorchester, NE

Scott Heinrich  
Ayr, NE

Clayton Hergott  
Hebron, NE

Schweitzer Red Angus  
Milford, NE

Dennis Hennerberg  
Diller, NE

Bruning Farms  
Bruning, NE

Schnuelle Ranch  
Jansen, NE

Brian Schardt  
Deshler, NE

Rock Creek Braunvieh  
Fairbury, NE

Mark Goes  
Beatrice, NE

S Diamond Angus  
Henderson, NE

Ed Durst  
Washington, KS

Dick Heinrichs  
Hebron, NE





# 2018 CATTLEMEN'S BALL



RIGHT SIDE

WELCOME TO  
HEBRON, NEBRASKA



LEFT SIDE

ON THE  
OREGON TRAIL



Right Side Buttstock

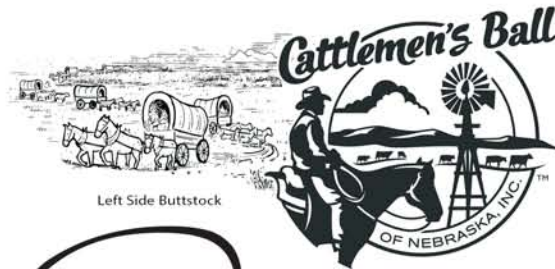

Left Side Buttstock

Serial # 1= Nate & Kristi Casey *in Memory of*  
Marlene Casey & Twila Widman

Serial # 2= Darrel Springer

Serial # 3= Darrel Springer

Serial # 4= Darrel Springer

Serial # 5= Darrel Springer

Serial # 6= Darrel Springer

Serial # 7= Hebron Plumbing - Rich & Cheryl Koch

Serial # 8= Doug & Cindy Lottman

Serial # 9= Lenny & Carla Bowman

Serial #10= Petersen LP Gas

Serial #11= Dick Walsh - State Farm

Serial #12= Ken & Pam Degenhardt *in Memory of*  
Mark Degenhardt

Serial # 13=Jason & Jody Degenhardt

Serial # 14=New Frontier Ins. *in Memory of*  
Larry Dankenbring

Serial # 15=Blue Valley Door *in Memory of* Jeni Parde

Serial # 16=Brad Coordsen *in Memory of* Walter Coordsen

Serial # 17=Joey & Audra Hergott Family

Serial # 18=Chris & Tara Huber

Serial # 19=Lathan & Stacey McLaughlin *in Honor of*  
Charlie Kelly

Serial # 20=Alexander Motor Co.

Serial # 21=Lance Fiala *in Memory of* Larry Fiala

Serial # 22=Citizens State Bank

Serial # 23=C & M Supply - 81 Express

Serial # 24=Trilyn Insurance Co. *in Memory of* Cheri Barker

Serial # 25=Tonniges Chevrolet

*Sponsors*  
 **HENRY**  
Made In America, Or Not Made At All

**Thank you** to the following individuals, businesses, and families for sponsoring these beautiful, limited edition collector firearms. The rifles will be sold during **Live Auctions** throughout the two-day ball event. Thanks also to Historical Armory, Inc. and to Henry® for their assistance and support of the 2018 Cattlemen's Ball of Nebraska.



# PROMISE PETALS

The Cattlemen's Ball dedicates itself to the promise of providing funds for the Fred & Pamela Buffett Cancer Center to help eradicate cancer. Promise Petals encourage us to remember those we have lost to this horrible disease, those who are currently fighting, and those who have survived. For a donation of \$100, contributors purchase a sponsor plant as a memorial or as a celebration of survival. The plants are professionally nurtured and cared for to their full size and then placed in our Serenity Tent & Garden for everyone attending the Cattlemen's Ball to view and enjoy.

This year's Promise Petals are a beautifully potted flowering plant. To those who have sponsored a Promise Petals plant (with your pre-event donation of \$100) after 4:00 PM on Saturday, you are free to take your plant home to enjoy.





# Cattlemen's Ball of Nebraska

## Back Yard Retreat

### 2018

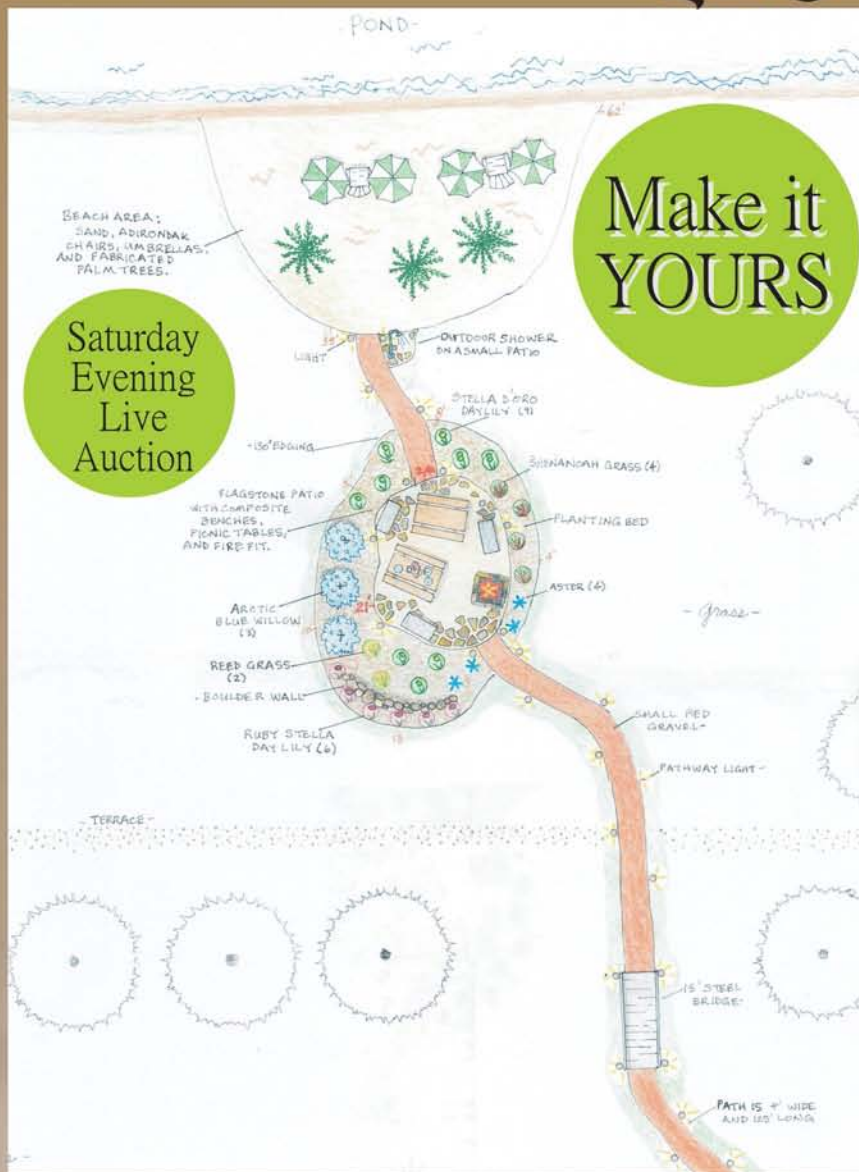

The beauty of nature, the serenity of the outdoors - this exquisitely landscaped oasis could be yours to enjoy for years to come! BID on it for your own home or cabin during the Saturday evening LIVE AUCTION, knowing that with your winning bid, you helped WHIP CANCER on the Oregon Trail!

Exclusive, professional installation by **All-Around Lawn & Landscaping** required. Additional installation charges apply.

**Back Yard Retreat to WHIP CANCER on the Oregon Trail includes:** flagstone patio, boulders/boulder retaining wall, landscape lighting, benches, picnic tables, plants, shrubs, trees, landscape beds with edging and mulch, fire pit and walk bridge.

#### Co-sponsors include

- Nichols Construction Co.
- Hebron Electric
- Exeter Lumber
- Hergott Enterprises
- Jay Krehnke & Lenny Bowman
- Jensen Lumber
- Kenny Lumber
- Mead Lumber
- Plains Tree Farm
- Remco, Inc.
- Shickley Lumber
- South Central Irrigation
- Unbroken Kustoms
- Gregg & Janice Wiedel
- 34 Electric

along with...



**ALL AROUND**  
—Lawn & Landscaping—

Located at the Fairmont Air Base

Hours: Saturday 9am-5pm  
Monday-Friday by Appointment

Office: 402 • 759 • 3100  
Mobile: 402 • 984 • 4588

Contact us for complete landscape design and installation, landscape maintenance, lawn care and maintenance

Ponds, Waterfalls & Streams • Flagstone Pathways & Patios • Wall Stone & Boulder Retaining Walls • Flowerbeds, Rock Gardens & Berms • Plants, Shrubs and Ornamental Grasses • Ornamental Shade and Evergreen Trees • Landscape Lighting • Landscape Bed Irrigation • Sodding • Dirt Work • Pruning & Trimming • Mulching • Landscape & Flowerbed • Cleanup and/or removal • All aspects of lawn care and maintenance.



# CALF FOR A CURE DONORS

Sp By: Prairie Hill Ranch,



"The 2018 Calf-For-A-Cure program invited and encouraged anyone and everyone, regardless of their involvement in the beef industry, to support the Cattlemen's Ball of Nebraska in it's quest to Whip Cancer by "virtually buying a calf."

A donation of \$1,000, along with that of other donors, purchased a pen(s) of feeder cattle during the fall of 2017. The cattle were placed on feed and grown to market weight at the Duensing Feedlot (Trey & Tobe Duensing) near Byron, Nebr. To protect the investments made in this program, the cattle were price-protected and insured. Feed costs and yardage were also reduced or fully paid by generous donations of cash, grain, and distillers from other commercial supporters, further enabling the program's success.

The Calf-For-A-Cure program proceeded as planned, and allowed for the full value of the finished animals to be reached by spring 2018. The final value of the finished animals has since been added to the array of other donations already contributed to the 2018 Cattlemen's Ball of Nebraska and will be included in our total dollars earned, for use in ongoing cancer research at the Fred and Pamela Buffett Cancer Center in Omaha.

2018 Calf-For-A-Cure program donors can be identified by the special red and white ear tag lanyard they are wearing.

Rob & Natalie Marsh, Hebron, NE

Richard & Cheryl Walsh  
Hebron, NE

David Mussmann, Ruskin, NE

Wiedels Circle E, Hebron, NE

Southeast Valley Irrigation, LLC  
Bruning, NE

Tracy Kennedy Agency, Hasings, NE

Berwyn Petersen, Ruskin, NE

Neil Wiedel/Wiedel Hay, LLC  
Hebron, NE

Mike and Ellen Long LLC,  
Hebron, NE

Mlinar Insurance Agency Inc  
Saint Paul, NE

Craig Marmie, Lincoln, NE

Chris J Conrad Ins Agency, Inc  
Crete, NE

Linda Maiden, McCook, NE

Brenda Henning Ins Agency, Inc.  
Seward, NE

Dennis & Barbara Ahlman,  
Littleton, CO

Lloyd & Marion Van Cleef  
Hebron, NE

Steven & Jody Heinrichs  
Shickley, NE

Rex & Karen Biegert  
Shickley, NE

Janet Kugler, Holdrege, NE

Gregg & Janice Wiedel, Hebron, NE

Kennel Seed & Ag, Davenport, NE

## IN MEMORY OF OUR BANKER FRIEND KOREY SCHOW OF PAXTON NEBRASKA WHO DIED OF CANCER IN 2015

Patrick & Carlece Kenner

James & Janice Kenner

Kurt & Marcia Yost

Sandbur Ridge Red Angus

Ross & Danielle Knott

Farmers & Merchants Bank of Ashland

Robert & Karen Fricke

Tri-County Bank

Jon & Jennifer Schmaderer

First State Bank-Hordville

Bill & Tina Anderson

Firstier Bank-Holdrege

John Nelson

Brunswick State Bank

Chris Twibell

Steve & Anne Ausdemore

Citizens State Bank





# CALF FOR A CURE DONORS

Sp By: Prairie Hill Ranch

Dirk Johnson, Shickley, NE	Jerry & Jill Catlett, Bruning, NE	Dennis Lichti Shickley, NE
Thayer County Livestock Feeders Assn., Inc.	Shuck Drilling Company, Edgar, NE	Joseph G. Hergott, Jr./Hergott Farms Gilead, NE
Elting Farms, Edgar, NE	Jack Wehrbein, Hebron, NE	Bradley Coordsen, Jansen, NE
David & Ann Bruntz, Friend NE	Elting 1950, Kerwin, Patty, Carl Edgar, NE	Marjure Coordson, Hebron, NE
Voss Seed, LLC/Leroy & Carol Voss Bruning, NE	Thayer County Farm Bureau Hebron, NE	Audrey Else, Hebron, NE "In Memory of Loren Else"
River Run Ranch, Inc. Alan & Susie Wiedel, Hebron, NE	Craig & Debra Pope, Hebron, NE	Lee Shavlik, Elgin, NE
John Greer, Edgar, NE	Hebron Plumbing, Inc. Hebron, NE	MAT Farms, Inc. Davenport, NE
Lynn Greer, Edgar, NE	Dwayne & Joan Lindhorst Lindsay, NE	Dale & Lori Schardt Carleton, NE
Ron & Bonnie Mumm, Chester, NE	Priefert Angus Hebron, NE	HMR Consulting, Inc. Bruning, NE
Double E Land & Cattle Belvidere, NE	Eickman Farms John & Kandy Eickman	Holtzen Livestock, Inc. Davenport, NE
Spenser & Jessica Else Belvidere, NE	Burwell Feeders & TTT Farms Burwell, NE	Debra Hansen, Wisner, NE
Engle Cattle, Geneva, NE	Alan & Sue Niederklein, Tobias, NE	Calver/Tordrup Group, Lincoln, NE
Darrel & Rhonda Saltzman, Shickley, NE	Daniel Poppe, Chester, NE	Richard & Connie Calver, Lincoln, NE
Roode Feedyards, LLC, Fairbury, NE	Steve & Beth Siebecker, Superior, NE	Heath & Mike Eitzmann/3E Cattle Republic, KS
Stockman Farms LLC, Yutan, NE	Monte J. Gehle, Chester, NE	Greg Eitzmann, Republic, KS
Rex & Mitzi Zenger Manhattan, KS	Burl Holmes, Byron, NE	Drinnin West Cattle Co Inc. Columbus, NE
James & Ivy Klug, Columbus, NE	Sheila Jackson, Byron, NE	Sandy Ridge Cattle, Inc. Fullerton, NE
G & K Holtmeier, Inc, Tobias, NE	Brad Elting & Company ,Inc Hebron, NE	Rishel Angus, Lincoln, NE
Dick & Ann Miles McCool Junction, NE	Ron Williams, Hebron, NE	Sheri Folkerts, Bruning, NE "In Memory of Alan Folkerts"
Carlson Irrigation, Inc, Shickley, NE	Kory & Jamie Koch, Edgar, NE	
James & Mona Wehrbein, Hebron, NE	Doug & Kathy Holtzen, Davenport, NE	
Dale Wiedel, Hebron, NE	Alfs Well Drilling Co, Shickley, NE	
Western National Bank, Chester & Byron, NE	Darrel & Deborah Johnson Shickley, NE	
Ron & Ann Lindvall, Edgar, NE		
Brad Coordsen		

## ALL CANCERS

Honoring Those Affected | 57





# — CALF FOR A CURE DONORS —

## Sp By: Prairie Hill Ranch

James & Karla Bohling, Scandia, KS	Don & Joanne Lubben, Bruning, NE	Fairbury Livestock Co, Fairbury, NE
Austin Schweitzer, Milford, NE	Donald & Jayne Kracke, DeWitt, NE	Larry & Deb Junker, Fairbury, NE
Shickley Grain Co. Shickley, NE	Ken & Jeanette Else, Hebron, NE	Larry Lange Family, Carleton, NE
Mrs. Roger (Jacqueline) Wiedel Hebron, NE	Carla, Chris & Ronda Frye/ Frye Family, Hebron, NE	Bryan & Ann Hubl, Hebron, NE
C Peter McClymont, Lincoln, NE	Don Templin Family, Hebron, NE	Karen Vorderstrasse, Deshler, NE
Galen & Gwendolyn Frenzen Fullerton, NE	Jerry & Angela Baysinger, Bruning, NE	Bruning/Davenport FFA, Bruning, NE
Max & Sue VanSkiver, Nelson, NE	Rob & Dana Crumbliss, Fairfield, NE	Darrell & Janice Raum, Hebron, NE
David Woods, Fairfield, NE	Mead Cattle Company, LLC, Mead, NE	Hebron Central Market Inc. Hebron, NE
Mark & Suzanne Jagels & Jason & Katie Jagels, Davenport, NE	Reynolds/Wallace Group, Ansley, NE	Mid States Rodeo, Broken Bow, NE
Scott & Kimberly Ford Cross Diamond Cattle Co. Bertrand, NE	Voss Seed, LLC, Bruning, NE	Duane & Brenda Rippe, Hubbell, NE
Agri-5, Inc./ Chris Meyer & Teresa Frahm Meyer Edgar, NE	Jody Houck, Strang, NE Doug & Janelle Bruning, Bruning, NE "In Memory of Scott Houck"	Stormy Valley Farms, Inc./ Brian & Heidi Isernhagen Deshler, NE
Hinrichs Seed, LLC, Shickley, NE	Myers Bros Farms, Geneva, NE	Landon & Leann Heinrichs, Hebron, NE
Schroeder Cattle, Davenport, NE	Theis Ag Sales, Geneva, NE	SEE Consulting, LLC/ Sally Else & Neal Hansen Denver, CO
Tietjen & Son, Byron, NE	Heitmann Farms Inc, Chester, NE	Krueger Sisters, Hebron, NE
Douglas & Debra Carr, Gilbert, AZ	"Kent Kriesel, Hebron, NE "In Memory of Walter & Nadine"	Joleen Gebers, Hebron, NE "In Memory of Vernon Gebers"
Megan Holmes, Papillion, NE	Birky, Whitley, Tatro, Schweitzer/ BWTS Farms	Upstream Ranch, Taylor, NE
Ashton Holmes, Byron, NE	Strang, NE, Geneva, NE, Ohiowa, NE	Mankato Livestock, Inc. Mankato, KS
Brigett Effenbeck, Deshler, NE	Welch Farms Inc, Hubbell, NE	Sudbeck Ag & H4 Farms, Inc. Hebron, NE
Semloh Farms, Inc. Byron, NE	Richard & Karen Reeb, Shickley, NE	BraseLand, Inc./ Jerry & Virginia Brase Davenport, NE
Cary & Amy Tietjen, Chester, NE	Ken & Pam Degenhardt, Hebron, NE	Bill & Gina Hudson, Belvidere, NE
	Les & Joetta Brandt, Ruskin, NE	Bob Marsh/Marsh Farms Belvidere, NE
	Dave & Joann Bruning, Bruning, NE	Thayer Central Schools, Hebron, NE
	McCoy Insurance, Arapahoe, NE	
	Gardels Farms, Inc. Wilcox, NE	
	James & Mary Rauner, Hebron, NE	
	Don Dowdy & Sons, Carleton, NE	





# — CALF FOR A CURE DONORS —

## Sp By: Prairie Hill Ranch

Flying H Genetics, Arapahoe, NE	Countryside Vet Clinic & Equine Reproductive Center Fairbury, NE	Scott Eitzmann, Hardy, NE
Bruning Grocery, Inc. Bruning, NE		Alan & Sue Porter, Chester, NE
Thayer Central FFA, Hebron, NE	Meghan Anderson, Ayr, NE	Farmer & Son Funeral Homes, Inc. Geneva, NE
"In Memory of Shelley German & Jessica Thompson"	Roth Feed Lots, Inc. Wisner, NE	Thayer Central Elementary Hebron, NE
Aubrey Saltzman Cattle, LLC Shickley, NE	"In Memory of George Lahners" Carleton, NE	Sasse Farms, LLC, Deshler, NE
Rick & Patrice Hoffman, Edgar, NE	Dave Rolf, Pilger, NE	Siebenneicher Wagon Wheel Ranch Hebron, NE
Colby & Trudy Degenhardt Hebron, NE	Kevin & Paula Hoops, Byron, NE	Cast & Crew of the Last Supper Pageant
Hergott Enterprises, Inc./ Randy & Becky Hergott Hebron, NE	Dave Meyer/ The Home Agency Ruskin, NE	John & Betty Boitnott, Hebron, NE
Lonnie & Chris Wiedel, Hebron, NE	Beth Sheridan Bartell, Sutton, NE	Rain and Hail Ace American, Rich- mond, IN
Joe Murray, Deshler, NE	Andrew & Kendra Else, Hebron, NE	BP Farms, Inc./Vicki & Steve Shaw, Edgar, NE
Evelyn Thompson, Guide Rock, NE "In Memory of Jessica Thompson"	Terry & Laura Tuma, Hebron, NE	Don & Brenda Betten, Hebron, NE
Kendall Schlake, Fairbury, NE "In Memory of Norma Jean Schnuelle"	Charles & Katholene Fangmeier Hebron, NE	Shickley FFA Alumni Assn, Shickley, NE
Nutsch, Inc. Chester, NE Earth Moving Contractor	Byron Lions Club, Byron, NE	Tipton Family Farms/Mike Tipton, Chester, NE
Dean & Linda Krueger, Hebron, NE	Dick Templin Family, Hebron, NE	Jon & Karen Lichti, Shickley, NE
Kelly & Kay Elting, Hebron, NE	Wiedel Brothers, LLC, Hebron, NE	Connealy Angus, Whitman, NE
Roy & Rosemary Anderson Family, Guide Rock, NE	Berwyn Petersen, Ruskin, NE	
Kuhlmann Farms LLC, Byron, NE	Ron & Nancy Kvols, Wisner, NE	
Bruce Freitag, Byron, NE	Elmer Holmes, Byron, NE	
Hoops Seeds/Lonnie Hoops, Byron, NE	Alan & JoAnn Svajgr, Cozad, NE	
Rock Hill Ranch, Hebron, NE	Russ & Mike Schroeder Davenport, NE	
Miller Seeds/Jerry & Heidi Miller Fairbury, NE	Kent Wiedel, Corona, CA	
Fairbury Animal Clinic, Fairbury NE	Jack Priefert, Hebron, NE "In Memory of Marily Priefert"	
Valley Creek Ranch, Fairbury, NE	Hubbell Lions Club Hubbell, NE	
	Don & Lucy Wegener, Hebron, NE	

**Whip**  
**ALL CANCERS**

Honoring Those Affected | 59





# CASH DONORS

## DIAMOND TRAIL BOSS (\$50,000 - \$99,999)

- Bruning State Bank
- Glenn H. Korff Foundation
- Herbster Angus Farms
- Thayer County Health Services Foundation & Guild

## PLATINUM TRAIL BOSS (\$25,000 - \$49,999)

- Cargill, Inc.
- First National Bank of Omaha
- Norder Supply, Inc.
- Thayer County Bank
- The Hawks Foundation
- Valmont Industries, Inc.

## GOLD TRAIL BOSS (\$10,000 - \$24,999)

- Bar T Cattle Company
- Charles Sargent Irrigation, Inc.
- Cornerstone Bank
- Crop Production Services
- Diamond 6 Feeders, Inc.
- Farm Credit Services of America
- Farmers Cooperative
- Fillmore County Hospital
- FuturesOne
- John Musgrave
- Mike and Ellen Long
- National Beef
- Pinnacle Bancorp, Inc.
- Renewable Fuels Nebraska
- Richard P. Kimmel & Laurine Kimmel Charitable Foundation, Inc.
- The Struve Foundation
- Tim & Lois Norder
- Merck Animal Health

## SILVER TRAIL BOSS (\$5,000 - \$9,999)

- Black Hills Util Holdings, Inc.
- Brodstone Memorial Hospital
- Burwell Public Schools
- Christensen Cattle Co., Inc./Sandy Ridge Cattle, LLC/DBL, Inc.
- Cuming County Feeders Assn, Inc.
- Dick Walsh Ins. Agency, Inc.
- DuPont Pioneer
- Frank and Mary Bruning
- Jeff and Sally Biegert
- Jerry and Jill Catlett
- Lichti Bros. Oil Co., Inc.
- Lone Creek Cattle Company
- Mark and Jan Knobel
- MetalQuest Unlimited, Inc.
- Nate Casey/Thayer County Farm Bureau
- Nebraska Farm Bureau Services, Inc.
- Prairie Hill Ranch, Inc.
- South Central Irrigation
- Jennifer Reinke
- Tim and Karen Else
- Tobe Duensing Family
- Union Pacific
- Wilson Trailer Company





# CASH DONORS

## SILVER (CONT.)

- Dick & Cheryl Walsh
- Paul & Lori Hogan/Home Instead Senior Care

## BRONZE TRAIL BOSS (\$2,500 - \$4,999)

- Aksamit Energy Development
- Bruning Grain & Feed Co.
- Coddington Medical Family Practice, LLC
- Edgar Grain Company/Darrel Springer
- Five Points Bank
- Flint Hills Resources
- Fortify Group
- Harry Knobbe Feed Yards
- Holmes Murphy & Associates, LLC
- In Memory of George Lahners
- Jefferson Community Health & Life
- Midwest Bank
- Sandman Family Foundation
- Settje Agri-Services & Engineering, Inc.
- T-L Irrigation Company
- Union Bank & Trust
- Wagon Hammer Ranches
- Wells Fargo Foundation

## COPPER TRAIL BOSS (\$400 - \$2,499)

- Certified Truck & Trailer Repair, Inc.
- Jason & Blair Pribyl
- Lisa Ricenbaw
- Luebbe Farms/Jeff & Melissa Luebbe
- Stonebrook Exterior
- Milligan Ins Agency
- Bob & Jill Milton
- Wayne & Lorri Milton
- Tuttle, Inc.
- Katz Silage Harvesting, LLC
- Centennial Plastics, Inc.
- Alan & Noreen Songster
- Frances Rohla
- In Memory of Henry J Rohla Sr
- Peggy Schoen
- Olsson Associates
- In Honor of Jamie Koch
- Friedman Law Offices, PC, LLO
- Precision Seed & Chemicals, LLC
- Scott & Lori Vyhnalek
- Bruntz Farms Inc
- Bar EB Farms, LLC
- HRW Farming
- Milton Bros Implement Inc
- Spohn Farms Inc

## COPPER (CONT.)

- Weber Feedyards
- Kevin & Leslie Songster
- Hebron Lions Club
- Hebron Country Club

**ALL CANCERS**

Honoring Those Affected | 61





# — IN ★ KIND DONORS —

## TITANIUM

(\$100,000 & Above)

- Priefert Manufacturing Co., Inc., Mount Pleasant, TX
- Reinke Manufacturing Co., Inc., Deshler, NE

## DIAMOND

(\$50,000 to \$99,999)

- Tyson Fresh Meats

## PLATINUM

(\$25,000 to \$49,999)

- Bruning State Bank
- Flood Communications, Fairbury, NE
- Great Plains Communications, Blair, NE
- Sandhills Publishing, Lincoln, NE
- Woodhouse Auto Family

## GOLD

(\$10,000 to \$24,999)

- Aurora Cooperative, Aurora, NE
- Clarks Ag Supply, Clarks, NE
- Dale Baden Pivot Service, Alexandria, NE
- Farm Credit Services of America
- JEO Consulting Group
- Patricia Schardt/Schardt Foundation
- Timpfe, Inc., David City, NE
- Titan Trailer Manufacturing, Inc., Waterville, KS
- Vern Friesen Gallery, Henderson, NE
- Viaero
- All Around Lawn & Landscaping, LLC., Fairmont, NE
- Charles W. Herbster, Falls City, NE
- Moeller Electric, Inc., Byron, NE

## SILVER

(\$5,000 to \$9,999)

- Ann Miles, McCool Junction, NE
- Alf's Well Drilling Co., Shickley, NE
- Ashley Spitsnogle, Omaha, NE
- Bruna Implement Co., Washington, KS
- Bruning Farms, Bruning, NE
- Don & Marilyn Deitemeyer, Doniphan, NE
- Dubas Equipment LLC, Fullerton, NE
- Feeding Systems, LLC, Columbus, NE
- Feedlot Fencing, LLC, Bruning, NE
- Hotwoods, Grand Island, NE
- Governor Pete Ricketts & First Lady Susanne Shore, Lincoln, NE
- Jane Green & Chancellor Ronnie Green, Lincoln, NE
- KanEquip, Inc., Syracuse, NE
- LandMark Implement, Holdrege, NE





# IN★KIND DONORS

## SILVER CONT.

(\$5,000 to \$9,999)

- Shelley Bursik  
Kuzma(Boisset Collection),  
Lincoln, NE
- Hog Slat, Inc.,  
Newton Grove, NC
- Linn Post & Pipe, Inc.,  
Linn, KS
- Minden Machine Shop,  
Minden, NE
- Murphy Tractor & Equip-  
ment Co., Lincoln, NE
- Polansky Seed,  
Belleville, KS
- Rod & Lorita Zohn,  
Stephan & Rachel Zohn,  
Jamestown, KS
- Strobel Manufacturing, Inc.,  
Clarks, NE
- Tobe Duensing,  
Byron, NE
- Williams Drilling Co., Inc.,  
Belvidere, NE
- Rob & Natalie Marsh,  
Gregg & Janice Wiedel,  
Mike & Ellen Long, John &  
Lynn Greer, Dick & Cheryl  
Walsh
- Karla Deepe, Deshler, NE
- Superior Outdoor Power  
Center, Superior, NE

## BRONZE

(\$2,500 to \$4,999)

- Allison Fees Varah,  
Ansley, NE
- Bill's Volume Sales, Inc.,  
Central City, NE
- BioZyme, Inc.,  
St. Joseph, MO
- Borsheims Fine Jewelry &  
Gifts, Omaha, NE
- Bradford Built, Inc.,  
Washington, KS
- Butler Ag Equipment,  
Pickrell, NE
- Central City Scale,  
Central City, NE
- Darren & Denese Sudbeck,  
Hebron, NE
- Double Barrel Game Farm,  
McCool Junction, NE
- Ernie Weyeneth,  
Lincoln, NE
- Jerry & Heidi Miller,  
Fairbury, NE
- Lisa Levendofsky & Travel  
Transport, Inc., Sun City  
Center, FLLonesome River  
Ranch, Anselmo, NE
- Long Crop Service,  
Hebron, NE
- Marge Buescher, South  
Bend, NE

- Norder Supply, Inc.,  
Bruning, NE
- Omaha Steaks, Omaha, NE
- On The Hill Ag,  
Adams, NE
- Outdoor Tire, LLC,  
Omaha, NE
- RoadBuilders  
Machinery & Supply Co.,  
Grand Island, NE
- Plains Equipment Group,  
Geneva, NE
- S & S Bleachers,  
Stanton, NE
- Southeast Valley  
|Irrigation, Bruning, NE
- University of Nebraska-  
Lincoln
- Valarie Bard, Hardy, NE
- Dismal River Club,  
Mullen, NE
- Eric & Linda Nutsch,  
Chester, NE
- Stonebrook Exterior,  
Lincoln, NE





# — TRAIL BOSS TICKETS —

- Lynn Greer
- Doug & Janelle Bruning
- Alan Pospisil
- Gerald & Virginia Brase
- Steve & Marla Heinrichs/  
Hein Co Farms Inc
- Craig Pope
- Rex Biegert
- Darin & Denese Sudbeck/  
Sudbeck Agronomics
- Leann Heinrichs
- Susan Miller
- Ray & Sharon Bennett
- Matthew & Kami Shalhoob
- Don & Brenda Betten
- David McCracken
- Phillip & Debra Johnson
- Rolland Anderson
- Tamara Burd
- Mike Reeb
- Doug & Gail Brand/  
Brand's Maines
- Kathleen Rachow
- Debra Carr
- Wayne & Barb Aude/TFC  
LLC
- Mary Heinrichs
- Dan & Brenda Steiner
- Thomas Sullivan
- Brian Isernhagen
- Jane Smith/Just Plain Jane
- Jeremy Young/Town &  
Country Veterinary Clinic
- Dick & Ann Miles/Miles  
Cattle Co
- Dirk Johnson/DAJ Ag Pro-  
duction LLC
- Michael Sabbeth & Nancy  
Germer
- Anne Wegner
- David & Debra Mussmann
- Berwyn & Betty Petersen
- Richard & Karen Reeb
- Dean & Linda Krueger/No  
Sweat Farms Inc
- David & Ann Bruntz
- Vaughn & Vicki Hinrichs
- Steven & Bev Harms
- Jason and Jody Degenhardt
- Sallie Pfeifer
- Kory & Jamie Koch
- Douglas & Jody Huber
- Michael & Rhonda Starbuck
- Lloyd & Marion Van Cleef
- Brad & Nancy Elting
- Eleanor Rizek Family
- Yvonne Long
- Don & Lucy Wegener
- Wayne Pohlmann/Morning  
Star Farms
- Roy Montgomery/Mont-  
gomery Auction & Realty
- Gary & Donna Saltzman/  
Saltzman Inc
- Aubrey & Glenda  
Saltzman/Aubrey Saltzman  
Cattle LLC
- Gary & Nancy Hinrichs
- Ron & Gail Bopp
- Leann Hervert
- Bob & Cheryl Marsh
- Chris & Rhonda Frye
- Bradley Coordsen
- Remco Inc
- Deborah Schmadeke
- Frederik Ohles/Nebraska  
Wesleyan
- James Vorderstrasse
- Tim & DaNay Kalkowski
- Tom & Trudy Fick
- Laurie Smith Camp/US  
District Court
- Douglas & Pamela Young
- Herbert & Margaret Marsh
- Renee Zimmerman
- Cary Tietjen
- Heitmann Farms
- Alan & Susan Wiedel
- Charles & Katholene Fang-  
meier
- Al & Peggy Meier
- Alan & Deb Kenning
- Steve & Marla Heitmann
- Kendall & Dustin Fencil
- John & Idonna Kripal





# TRAIL BOSS TICKETS

- Gelbvieh Rippe
- Dana Crumbliss/DRC Farms LLC
- Lathan & Stacey McLaughlin
- Craig Nickman
- Tom & Sue Groeteke/Cedar River Ranch
- Lee Shell
- Leroy & Carol Voss/Voss Seed
- Paul & Connie Meyer
- Robert & Myrna Krohn
- Terry & Laura Tuma
- Jaye & Sheena Moeller
- Heath & Joanna Eitzmann
- Jason & Tara Kuhlmann
- Bill & Lindsey Escritt
- Clint & Layce Siemsen
- Travis & Cammie Freitag
- Dick & Phyllis Schoenholz
- Lavern & Jackie Eyer Potuzak
- John & Holly Mumm
- Wenske Repair LLC
- Tietjen & Son
- Gloria Thesenvitz/Nova-Tech Inc
- Dean Wilken/Mason Grove Land & Cattle
- Roger & Sharon Brandes
- Jenise Straight/Straight Farms
- Mark & Jane Gloor
- Susan Tonniges
- Pamela Pearson
- Don Batie
- ReJean Elting/Elting Farms
- William D Tomes
- Tara Young
- Tim & Lois Norder
- Darreld & Rhonda Saltzman
- Rob Miller
- Robert Else
- Mark & Suzanne Jagels
- Nancy Hofts/Amanda's Cottage
- Cheri Williams/Buckley Creek Ranch
- Tami Ayers
- Kristi Cookus
- Nancy Heinrichs/Heinrichs Family Farms
- Jack Underwood/Underwood Realty & Auction
- George Keilwitz/Hebron Liquor
- Richard & Sharon Paul
- Bob & Diane Baxa
- Mark Sullivan
- Mike Homolka
- Brent Stutzman/Blue River Cattle LLC
- Dennis & Patty Nun/Heartland International Inc
- Dr. Bryan & Ann Hubl
- Debbie Furstenaus
- Larry & Nancy Shavlik
- Lottman Ready Mix LLC
- Justin Shavlik
- Stephen Redman/Windermere Real Estate
- Emily Schmitz/ALLO Communications
- Petersen LP Gas
- Kelly & Pam Ficken
- Darlene Wiedel
- Myron Gehle & Misty Gehle, & Paul Fletcher
- Bruce & Judith Harms
- Monte & Rita Gehle
- Larry Junker/Fairbury Livestock Co
- Chris Hergott
- Ruth Yoachim
- Kenneth Korff
- Mary Arth
- Barry & Dorothy Renz & Family
- Jack Priefert
- Jim Hergott
- Lori Werner/By Design Inc
- Mark & Stephanie Boldt

**ALL CANCERS**

Honoring Those Affected | 65





# — TRAIL BOSS TICKETS —

- Lorie Monroe
- Troy Shuck
- Ron Welch
- Eric Kamler/Kamler Enterprises LLC
- Robert Morris
- Floyd & Donna Anderson
- Lee & Kara Shavlik
- Ralph & Deb Pelster
- Wesley & Lori Siebenneicher/Wagon Wheel Ranch
- Alan & Jo Ann Svajgr
- Kathleen Spahr
- Cheryl Hissong/81 Trailer Sales
- Steve & Jane Niewohner
- Steve & Jody Bousquet
- Jack & Sherril Mefford
- Greg Robb/Big Red Bunks
- Dennis & Janice Gengenbach/Gengenbach Farm
- Dianna Huss
- Darla Buell
- David Ibsen
- Michael Tomes/Tomes Farm Co Inc
- John & Linda Davis
- Tom Hawks/Metal Tech Partners
- DBL, Inc
- Les & Diane Hill
- Andy & Ellen Schmidt
- Marlyn Heitmann/Heitmann Farms
- Goebel Constructiion Inc
- Steven & Susan Anderson
- Jerry & Cheryl Miller
- Brent McDonald
- Adams Land & Cattle LLC
- Cynthia Hild
- Carol Schuetze/Territorial Magazine
- Laurie Widdowson
- Traci Kadel
- Greg Zoubek
- Chris & Tara Huber
- Jon Holzfaster
- Michael Tinkham
- Thad Mumm
- Michele O'Connor
- Robert Homolka
- Patricia Miller
- Sam & Sandra Page
- Todd Bremer/Bremer Farms
- Ken & Linda Flyr
- Margaret Small
- Quenton & Shelly Pulliam
- Bill & Gina Hudson
- Ben & Nicole Schoenholz
- Bruce McDowell/McDowell Auction Service
- Rodney Beranek
- Mike & Ambur Hinrichs
- Todd Mach
- Mark & Pam Spurgin/Spurgin Inc
- Lendon & Leone Thompson
- Charles Baum/Boehringer Ingelheim
- Douglas & Christine Wismer/Thayer County Health Services
- Julie Jones/Chundy Land & Cattle GP
- Douglas Schmitz/Black Hills Energy
- Tim Schmidt/Holdrege Irrigation Inc
- Lisa Johnson/Lonesome River Ranch
- Richard & Cindy Nelson
- Bryan & Janet Bernard
- Cory & Jeri Wiedel
- Kae Pavlik
- Eric & Jen Krupicka
- Richard Hoins
- Emily Gronewold/Jim Her-gott Construction
- Craig & Marge Buescher/Buescher Farms





# — TRAIL BOSS TICKETS —

- Guy & Carla Ellsworth
- Dixi Wellman
- Ron Dubbert
- Neal & Tara Voss/Voss Farms
- Joy Philippi/Images by J LLC
- Judi Kersten
- Sheryl Krapp
- David Wenske
- Frank & Shirley Sibert
- Heather Ramsey/HMR Consulting Inc
- Warren Mitchell
- Don & Deb Cantrell
- Laura Ebke
- Lou Kennedy
- Kevin Rasmussen/RB Angus
- Thomas & Lea Marsh
- Brian & Torey Keiser
- Chris & Carol Schuetze/CJ Land & Cattle
- Paul & Lori Johnson
- Kellen & Katie Jorgensen
- Kelvin & Marsha Jorgensen
- Loren Wiedel/Wiedel Brothers LLC
- Paul Medelman/Medallion Construction
- Alvin Glasshiff
- Elaine Werner
- Daniel Smydra/FMC Corporation
- Allison Sandman/Sandman Grow Yard LLC
- Travis & Leah Hays
- Todd & Tricia Grabenstein
- Cody Gulbrandson/Town & Country Vet Clinic
- Louis & Shirley Riha
- Mike & Camella Walters
- Ivan & Doris Rush
- Particia & Ronald Schardt Foundation
- Joey & Myra Large
- Alfred & Janell Hanson
- C Peter McClymont
- Mumm Hay Service
- Mick Cox/Mill Bar Angus
- Jeff & Becky Marshall
- Charolette Wallin
- Christina Krausnick/Krausnick Ranch
- Kati Ladenburger
- Mark Wiedel/MEW Ag LLC
- Rachel Eickman/Eickman Cattle
- Trenton Siebecker/Tall Pine Ag Supply Inc
- Tim Koch
- Dr. Travis & Abby His-song/Heartland Veterinary Service of Oberlin, P.A.



Honoring Those Affected | 67





## THAYER COUNTY HEALTH SERVICES KORFF FITNESS & WELLNESS CENTER



Thayer County Health Services is the primary health care provider in Thayer County. It consists of a Critical Access Hospital and clinic in Hebron, plus four rural medical clinics in Bruning, Chester, Davenport, and Deshler. Thayer County Health Services provides healthcare services to patients throughout Thayer County and the surrounding communities. They also provide preventive and wellness services to patients looking to lead a healthier lifestyle.

On August 2, 2015, Thayer County Health Services broke ground on a \$14.8 million hospital renovation and expansion project. Thanks to a generous gift of \$6.9 million from the estate of Glenn Korff, Hebron native, the first phase of the project included the new Korff Fitness and Wellness Center. This facility is a 17,000 sq. ft. addition on the Northside the hospital in Hebron.

The completed Korff Fitness and Wellness Center opened its doors in December 2016 and allowed Thayer County Health Services to add the following services:

### **Rehab Department** (Physical • Occupational • Speech Therapy)

- Aquatic Therapy
- Expanded occupational therapy (OT) training for daily living with an ADA kitchen, laundry and bathroom
- OT pediatric and therapy services
- Large gym and open exercise area for physical therapy
- Extra space to allow for additional equipment



Rehab Therapy Gym

### **Wellness and Fitness Center**

Amenities Include:

- Pool for walking and water aerobics
- Fitness equipment including free weights and machines
- Indoor walking track
- Dietician and nutritional counseling
- Personal trainer
- Aerobics room for exercise classes
- And more!

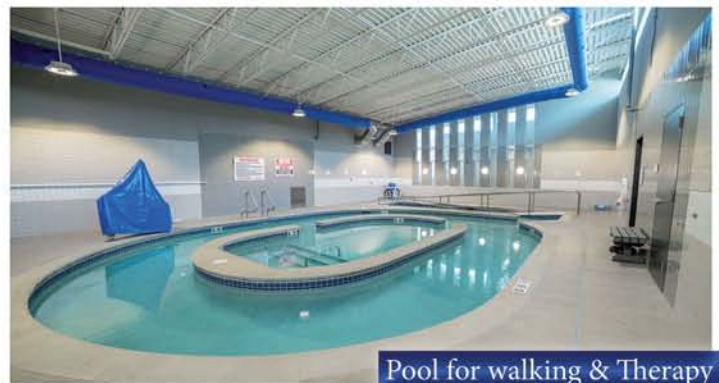

Pool for walking & Therapy

### **Fitness Center Gym**







# Thayer County Health Services

120 Park Avenue | Hebron NE 68370  
ThayerCountyHealth.com | 402-768-6041



Operating Room

The second half of the project included renovations to the hospital and the Hebron clinic. Improvements to the hospital included; relocating and expanding the kitchen and cafeteria, two new labor and delivery suites (LDRPs), specialty clinic, chemo room, Operating Room, expanding the surgical center, and moving the emergency room closer to the nurse's station.

In addition to the original renovation project, the Hebron medical clinic that was added in 1997 received a complete update. This final step of the project has allowed Thayer County Health Services to position itself to meet the current and future healthcare needs of the patients they serve.

Thayer County Health Services is honored to be a part of the 2018 Cattlemen's Ball and the fight against cancer. We couldn't be more proud of the individuals, organizations and businesses that have come together to make this event such a success. Everyone's generosity is why living in Thayer County is truly "The Good Life".

Emergency Room



Labor and Delivery Suite





# Here for you. Here for your future.

You need a bank that focuses on your ag operation's financial needs. We've been doing that for the past 160 years, so the next generation can be even stronger than the one that came before it.





# Priefert®



PRIEFERT IS FAMILY



AMERICA'S #1 NAME IN RANCH, & RODEO  
EQUIPMENT FOR OVER 50 YEARS...

CALL TODAY 800.527.8616 OR VISIT US AT [WWW.PRIEFERT.COM](http://WWW.PRIEFERT.COM)



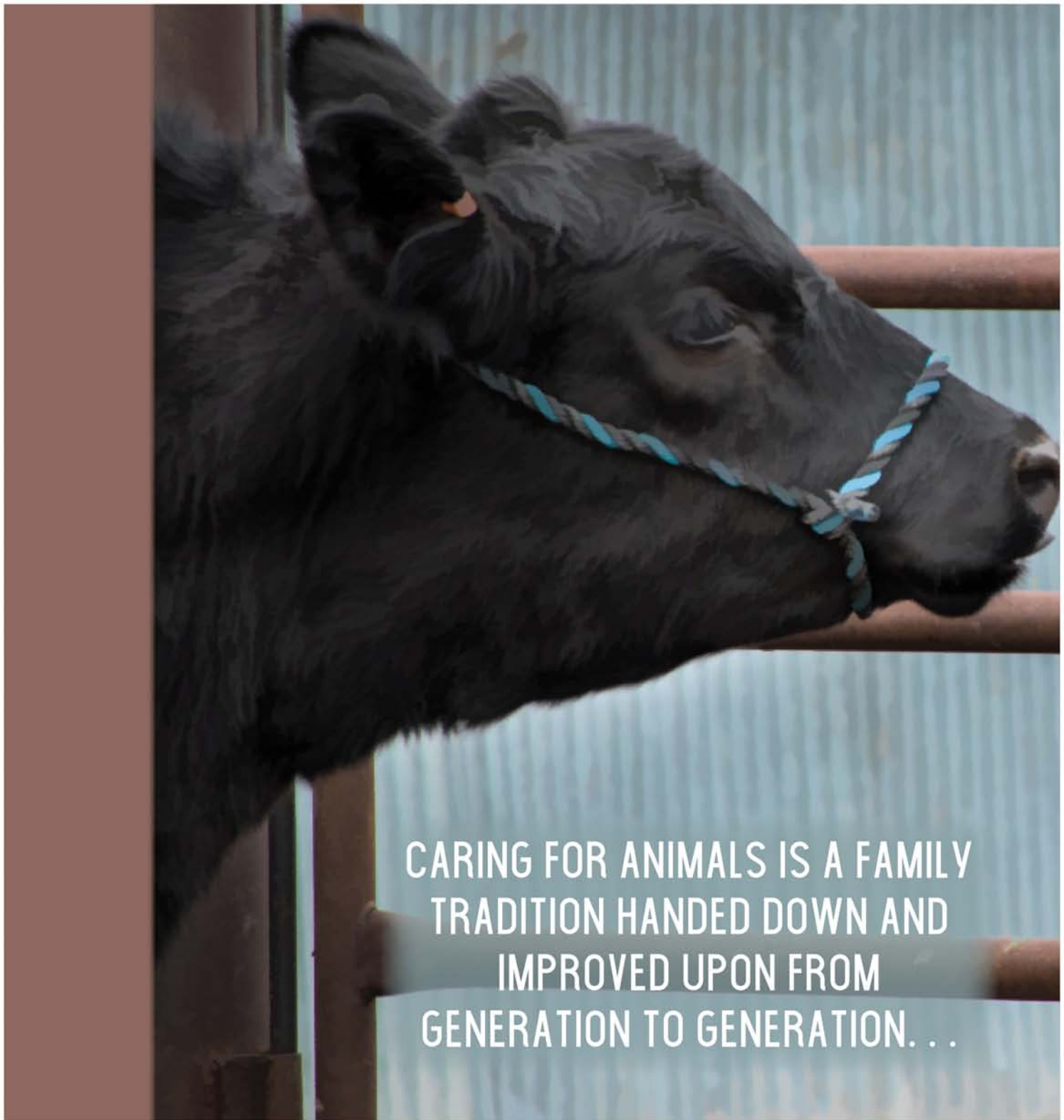

CARING FOR ANIMALS IS A FAMILY  
TRADITION HANDED DOWN AND  
IMPROVED UPON FROM  
GENERATION TO GENERATION...

For five generations we have been a family-owned bank. Our roots run deep in rural Nebraska, and agriculture has always been our foundation. Serving farmers, ranchers, and the local communities is our pleasure and our priority.

Stop by one of our locations or visit us online to learn more about our full range of financial services!





# BRUNING STATE BANK

*Your Country Bank*

[www.bruningbank.com](http://www.bruningbank.com)



Broken Bow 

Kearney 

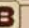
Holdrege 

Bruning 

Hebron 





**Proud sponsor of the  
Cattlemen's Ball of Nebraska**



*Thank you for supporting the  
Cattlemen's Ball of Nebraska*

*Together we can Whip Cancer!*

**Norder Supply, Inc.  
136 E Main Street, Bruning NE 68322  
1-402-353-6175**

*Bruning - Hebron - Shickley - Geneva - Byron - Juniata - Bladen -  
Blue Hill - Franklin - Aurora - Red Cloud - Maywood - Elwood -  
Wayne - Scott City KS - Garden City KS*



# Our founder changed the face of the earth.

In 1946, Robert Daugherty began his quest to conserve fresh water, one of the planet's most valuable resources. He helped agriculture producers see new paths to feeding our world's growing population. At Valmont, we're committed to *Conserving Resources and Improving Life* around the world. Thanks to Cattlemen's Ball of Nebraska and the Fred & Pamela Buffett Cancer Center, we're able to put our shared passion together to improve lives right here at home.

Learn more at [www.valmont.com](http://www.valmont.com).

**valmont** 







# LONECREEK

---

CATTLE COMPANY

Lone Creek Cattle Company's mission is to expand the Piedmontese cattle breed through bull development, verified procurement of feeder and finished cattle, and support for our network of ranchers across the Midwest. Our focus is raising healthy Piedmontese cattle through responsible stockmanship and animal husbandry, effective resource management, and farm-to-fork traceability.

Lone Creek's bull lease program provides lucrative and sustainable business opportunities for progressive commercial cattlemen and women.

- Low bull lease fees
- Guaranteed purchase
- Competitive calf premiums
- No sale barn costs, transportation costs, or broker fees
- No bull battery maintenance costs outside of breeding season
- Artificial insemination from high-performance Piedmontese bulls





Defining what's important.

*adjective*

# LO-CAL

Community-grown and focused.



## Pinnacle Bank

THE WAY BANKING SHOULD BE



[pinnbank.com](http://pinnbank.com)

MEMBER FDIC 

# "FOR US, IT'S NOT JUST YEARLONG SUPPORT — IT'S LIFELONG DEDICATION!"



Long Crop Service LLC

**Mike**

402-768-8615

**Andy**

402-768-1846

**Chris**

402-768-8275

**Heidi**

785-556-9143

Our commitment to growers doesn't stop when the season ends.  
We're in it for the long haul — providing support, insights and  
industry-leading products to help you achieve success, year after year.



**WITH  
YOU**  
— FROM THE —  
**WORD GO**

PIONEER® brand products are provided subject to the terms and conditions of purchase which are part of the labeling and purchase documents. ®, ™, ™ Trademarks and service marks of DuPont, Pioneer or their respective owners. © 2017 PHIL. DUPPBR17049VA 17D-1544





**KanEquip**  
Inc.™

Join us in the fight  
against cancer.

Learn more at

[www.SurvivorTractor.com](http://www.SurvivorTractor.com)



Proud to be your  
New Holland Dealer in

Syracuse, NE 402-269-2310  
Marysville, KS 785-562-2377



**CNI**  
INDUSTRIAL

GENUINE  
PARTS



**Farmers Cooperative**

*Investing in Our Owners' Success!*



**PROUD SUPPORTER OF THE CATTLEMEN'S BALL**

**GRAIN • AGRONOMY • FEED • TIRES • LUBRICANTS • ENERGY**

**[www.farmersco-operative.com](http://www.farmersco-operative.com) • 800-642-6439**





# VIAERO WIRELESS: PROUD TO SUPPORT THE 2018 CATTLEMEN'S BALL OF NEBRASKA



Viaero Wireless is committed to keeping our neighborhoods and communities connected... Best prices, coverage and service.

# VERN FRIESEN

ORIGINAL OIL PAINTINGS AND BRONZE

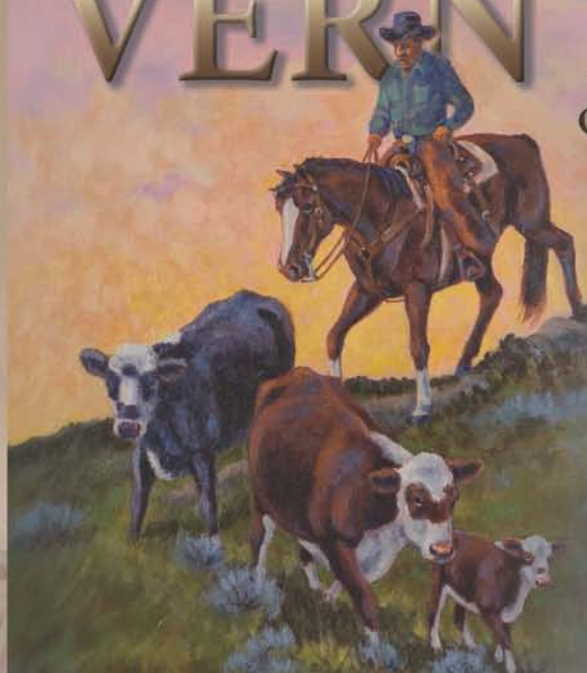

VERN FRIESEN - FRIESEN GALLERY

1053 N. Main Street | Henderson, NE 68371 | 402-723-4977 | [www.vernfriesen.com](http://www.vernfriesen.com)





*"You been  
farming  
long?"*

The **faith** of a child has been present at the Cattlemen's Ball, both past and present. To continue this faith is to **believe** in a tomorrow without cancer.

We cannot **harvest** the cancer cure for future generations without **sowing the seeds** of hard work and dedication to **cancer research**.

**BAR T**  
CATTLE COMPANY

*Roger & LeaAnn  
Tremayne*  
886 Highway 77  
Walthill, Nebraska 68067  
402.846.5855

**FILLMORE**  
COUNTY HOSPITAL

1900 F STREET • GENEVA, NE 68361

Fillmore County Hospital is an Equal Opportunity Provider and Employer.

**402.759.3167**

**WWW.MYFCH.ORG**

Fillmore County Hospital will be the regional leader for valued health services. Our Team will be recognized for its knowledge and compassion in delivering exceptional care, innovative services, and trusted outreach and education in all stages of life.

**TOUCHSTONE ORTHOPAEDICS**

**PEDIATRIC PUZZLE PIECES THERAPY**

**SENIOR INPATIENT BEHAVIORAL  
HEALTH FACILITY**

**INTEGRATED BEHAVIORAL HEALTH**

**OVER 15 SPECIALTY CLINICS**

**CANCER REHAB PROGRAM  
COMING FALL 2018**



# NEBRASKA CATTLEMAN

The ONLY publication dedicated to the Nebraska cattle industry.

## #1

Nebraska's 2017 ranking for U.S. cattle on feed.

## \$12.1 billion

The dollar effect of beef production on Nebraska's economy.

## 1.88 million head

The number of beef cows in Nebraska.

## 2.3 million head

The average number of cattle on feed in Nebraska.

Seedstock, ranch, farmer-stockman or feedlot – our readers raise and harvest forages and grains, purchasing equipment and supplies to do so. *Nebraska Cattleman's* 15,000-plus readers buy breeding stock, as well as a full range of products and services to produce and feed cattle and to raise crops. If your target market is cattle producers and feeders, 55% of whom also produce crops, *Nebraska Cattleman* is a unique vehicle for helping you promote and sell your products to them.

Magazine available online at  
[nebrascacattlemen.org](http://nebrascacattlemen.org).



Contact NC sales rep  
**Amber Coleman** to advertise.  
[acoleman@necattlemen.org](mailto:acoleman@necattlemen.org) or 402.340.1588

Photo courtesy of  
Larissa Reinert

## WHAT'S AN EAR TAG WORTH THAT FADES?

# NOTHING!

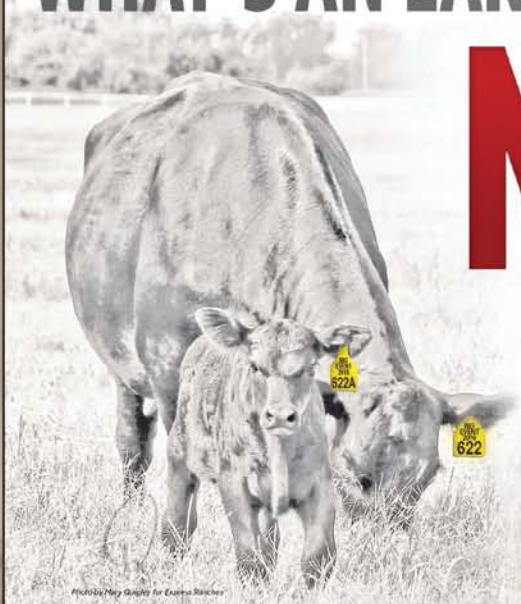
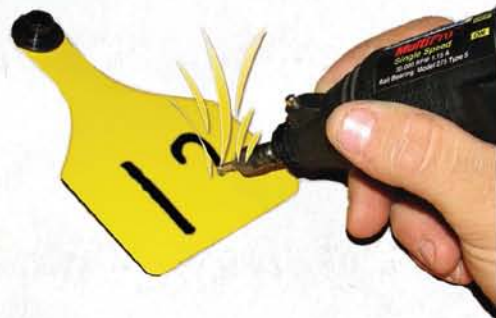

Photo by Terry Gaudin for Ritchey Tags

Our exclusive dual-colored tags are unsurpassed in readability.

Ritchey Tags allow for do-it-yourself or custom **permanent** engraving.

Ritchey is your source for custom designed tags.



**Ritchey** EST. 1964  
Livestock ID  
1-800-EAR-TAGS

[www.ritcheytags.com](http://www.ritcheytags.com)



# Generosity Changes Everything...

The Hebron Community is extremely proud to be called "home" for Kenneth Korff and the late Glenn Korff. The Korff's have been compelled to generously return gifts to the State and to our community for the education that they received in Hebron and for the work ethic and values they were given by the people of Nebraska. The Korff's many gifts, often given in honor of their parents, Paul and Esther Korff will continue to give through various endowments and gifts to many organizations. The new Korff Wellness Center at Thayer County Health Services in Hebron is just one example of many. As members of the Korff's hometown and as local hosts of the 2018 Cattlemen's Ball, Hebron takes great pride that one of its own was able to have a floor at the Fred & Pamela Buffett Cancer Center named in his honor. The Glenn Korff Precision Medicine Prostate Center of Excellence Fund at the University of Nebraska Foundation was established in 2015 with a 5 million dollar gift from Glenn's estate. Glenn died in 2013 from complications of prostate cancer but his legacy lives on.

*Thank You!*

Glenn and Kenneth Korff

Hebron Community Foundation



## SARGENT

### *Irrigation & Drilling*

Broken Bow

Grant

Geneva

Neligh

Aurora

Holdrege

Carroll IA

Salina KS

IRRIGATION WELLS  
TURBINE PUMPS  
PUMP REPAIR • EFFICIENCY TESTS



[WWW.SARGENTIRRIGATION.COM](http://WWW.SARGENTIRRIGATION.COM)



**Crop  
Production  
Services**



**Crop Protection • Nutritional  
Seed Treatments • Seed  
Custom Applications**

# PROUD SUPPORTER OF CATTLEMEN'S BALL

Serving the agricultural industry with professionals who have the expertise and access to an exclusive line of products to succeed in today's competitive market.

Find a location near you at [www.cpsagu.com](http://www.cpsagu.com)

**echelon**<sup>™</sup>

7620 Cattlemen's Ball C2718

## TOGETHER we can WHIP CANCER!

**Tracy Kennedy, Agent**

2632 W 2nd Street  
Hastings, NE 68901  
Bus: 402-462-2919 Fax: 402-462-2950  
[tlkinsurance.com](http://tlkinsurance.com)

**Linda Conrad, Agent**

210 W Eldora Avenue  
Weeping Water, NE 68463-4240  
Bus: 402-267-3435 Fax: 402-267-3475  
[linda.conrad.cffu@statefarm.com](mailto:linda.conrad.cffu@statefarm.com)

**Dick Walsh, Agent**

1248 Lincoln Avenue • PO Box 189  
Hebron, NE 68370-0189  
Bus: 402-768-6426 Fax: 402-768-6977  
Toll Free: 800-414-8515  
[www.agentdickwalsh.com](http://www.agentdickwalsh.com)

**Brenda Henning, Agent**

23 Main Street  
Seward, NE 68434-2111  
Bus: 402-643-4548 Fax: 402-643-0537  
[brenda@brendahenning.com](mailto:brenda@brendahenning.com)  
[www.brendahenning.com](http://www.brendahenning.com)

**Joe Mlinar, Agent**

1116 2nd Street  
St. Paul, NE 68873-1708  
718 O Street • PO Box 525  
Loup City, NE 68853  
Bus: 308-754-4662 Fax: 402-745-0741  
[Joemlinar.g94s@statefarm.com](mailto:Joemlinar.g94s@statefarm.com)  
[www.joemlinar.com](http://www.joemlinar.com)

**Steve McCoy, Agent**

514 Nebraska Ave • PO Box 560  
Arapahoe, NE 68922  
Bus: 308-962-5278 Fax: 308-962-6160  
[steve.mccoy.b6kg@statefarm.com](mailto:steve.mccoy.b6kg@statefarm.com)



**Chris Conrad, Agent**

1260 Quince Street • PO Box 262  
Crete, NE 68333-0262  
Bus: 402-826-5000 Fax: 402-826-3315  
Toll Free: 877-622-1930  
[www.chrisconradagency.com](http://www.chrisconradagency.com)

**Linda Maiden, Agent**

802 West B, Suite 101  
McCook, NE 69001-0917  
611 Paxton Street, Suite A  
Cambridge, NE 69022  
Bus: 308-345-6482 Fax: 308-646-0107  
[lindamaiden@lindamaiden.com](mailto:lindamaiden@lindamaiden.com)

Your Independent  
Agents Supporting  
the 2018 Cattlemen's  
Ball of Nebraska







*I don't know  
what tomorrow  
holds, but  
I know who  
holds tomorrow.*

# THE DESHLER RUSTLER

deshlerrustler@gpcom.net

Fax- (402) 365-4439

1-(402)365-7221

*Proud supporter of the 2018 Cattlemen's Ball & our future generations*

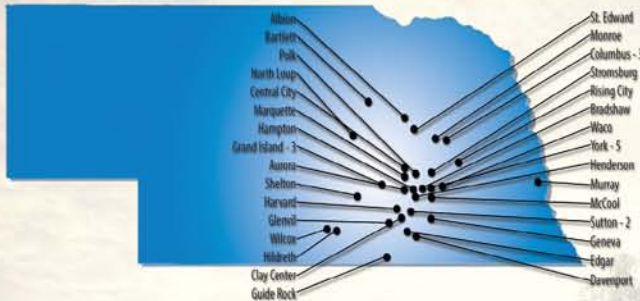

**Serving Nebraska since 1882 with  
40 Banks in 31 Communities.**

**Cornerstone<sub>BANK</sub>**  
Member FDIC

**Bank on a Solid Foundation**

cornerstoneconnect.com





## IF AGRICULTURE MEANS SOMETHING TO YOU, YOU MEAN EVERYTHING TO US.

Farm Credit Services of America is dedicated to the business of agriculture. It isn't just something we do, it's everything we do – an entire organization that spends every working day thinking, planning and investing in ways to serve you better. Discover the benefits of a lender committed to your success. Call 800-884-FARM.

**AGRICULTURE WORKS HERE..**



AGRICULTURE  
WORKS  
HERE.

NAME:  
Curtis & Marla

LOCATION:  
Oconto, NE

OPERATION:  
Beef & Grain  
Producers

View their story at:  
[fcsamerica.com/curtismarla](http://fcsamerica.com/curtismarla)



## Welcome to the CATTLEMEN'S BALL

DIAMOND  FEEDERS

294 18TH ROAD  
WEST POINT, NEBRASKA 68788  
402-372-5751  
[OFFICE@DIAMOND6.COM](mailto:OFFICE@DIAMOND6.COM)

PROUDLY DOING OUR PART TO  
FEED THE WORLD AND





# Cattlemen's Ball



*FUTURESONE fields of opportunity* <sup>TM</sup>

**BROKERAGE • RISK MANAGEMENT • MARKET ANALYSIS**



JEO CONSULTING GROUP

Proud Supporters of the

## 2018 Cattlemen's Ball



Engineering



Architecture



Surveying



Planning



Funding

[jeo.com](http://jeo.com) | 1.800.723.8567



**STREAMLINE  
YOUR  
OPERATION**

**SIDUMP'R**



*Still Faster, Still Stronger, Still More Reliable!*



2500 E. 23rd Street  
Columbus, NE 68601  
[www.sidumpr.com](http://www.sidumpr.com)

Office (402) 564-1400  
Fax (402) 564-1450

**FEEDING**  
*Systems*

[www.feedingsystems.biz](http://www.feedingsystems.biz)

**Ask how you  
can save time  
and money!**

**402-564-1400**



**National Beef®**

**America's Premier  
Beef Company™**

National Beef® is proud to support the 2018  
Cattlemen's Ball of Nebraska and a worthy cause,  
the Fred & Pamela Buffett Cancer Center.

National Beef Packing Company LLC. © 2018

Kansas City, MO 64163 • [nationalbeef.com](http://nationalbeef.com) • 1-800-449-BEEF







**TOUGHER TOGETHER**

*AUROMA & YOU*



**AUROMA  
COOPERATIVE**

# Choose American Ethanol

Toxic particles in  
vehicle exhaust  
can lead to:

*Asthma • Brain Cancer • Lung Cancer • Heart Disease*



When you choose fuel with higher blends of ethanol,  
you choose cleaner air and better health for everyone.

[www.AmericanEthanolNE.org](http://www.AmericanEthanolNE.org) | [www.HuskerFuel.com](http://www.HuskerFuel.com)



CLARKS AG SUPPLY

# EASILOAD

308-548-2555

Seed Systems

The Most FARMER FRIENDLY SYSTEM  
on the Market Today!

## The Three Box Lo-Pro EASILOAD SEED SYSTEM

### The Only Seed System Available With:

- Safe, low-profile design
- Available in 2, 3, 4, 6 box units
- 120, 200, & 300 unit bulk
- Double axle brakes
- Built like a seed tender
- Finger tip seed control
- Scale options available
- Estart Honda motors
- Powder coat paint
- Fabricated by certified welders
- Reaches any planter or drill
- Patented Easiloc lock down

[www.clarksagsupply.com](http://www.clarksagsupply.com) • 866-246-2588

# MOELLER ELECTRIC

Moeller Electric is a leader in the design, installation and maintenance of electrical systems. We offer consistent, competitive performance on a full range of commercial, industrial and residential projects.

We are qualified and equipped to handle the challenges and complexities of both large and small projects.

We pride ourselves in workmanship and performance.

**Commercial • Residential • Agricultural • Industrial**

**Electrical Wiring, Heating & Air Conditioning,  
Radon Testing and Mitigation, Security Systems.**

Locations in: Hebron, NE • 402-768-6289 / Byron, NE • 402-236-8619





# FEEDLOT FENCING LLC

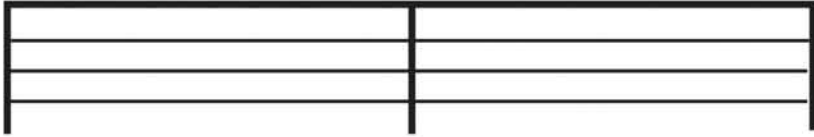

TUBING - PIPE - ROD - HIGH TENSILE FENCE - GATES - POSTS  
CREOSOTE POSTS - CLIPS - CAPS - GUARD RAIL - CONTINUOUS FENCE  
CUSTOM GATES MADE TO ORDER

402-353-4455 OR 888-216-4455 • WWW.FEEDLOTFENCING.COM

1 MILE SOUTH AND 1 1/4 MILES WEST OF BRUNING, NEBRASKA



*LARGEST STOCK IN THE MIDWEST - TRUCK LOAD DISCOUNTS AVAILABLE*

WWW.STONEBROOKEXTERIOR.COM

PROVEN BY **VISION**

RECOGNIZED BY **RESULTS**



## STONEBROOK EXTERIOR

**402-438-5559**

**COMMERCIAL & RESIDENTIAL**  
ROOFING | SIDING | WINDOWS | GUTTERS



Enriching  
Lives,  
Conserving  
Resources...



IMPROVING ANIMAL HEALTH AND  
WELL BEING OF ANIMALS  
PROVIDING ABUNDANT AND  
AFFORDABLE MEAT AND DAIRY  
PROTECTING THE ENVIRONMENT

THE SCIENCE OF HEALTHIER ANIMALS



## Fillmore, Saline, and Seward County Feeders and Farmers



Weber Feedyards Dorchester, Nebraska Joel Weber  
Jon and Jill Eberspacher Beaver Crossing, Nebraska  
Kevin and Leslie Songster Cordova, Nebraska  
Jason and Blair Pribyl Milligan, Nebraska  
Bob and Jill Milton Friend, Nebraska

Alan and Noreen Songster Exeter, Nebraska  
L and W Cattle Friend, Nebraska Wayne and Lorri Milton  
Luebbe Farms Goehner, Nebraska Jeff and Melissa Luebbe  
Scott and Lori Vyhnaelek Friend, Nebraska  
Lisa Ricenbaw Beaver Crossing, Nebraska

Bill and Brenda Bruntz, Allen and Amanda Bruntz Friend, Nebraska  
Tuttle Inc. Friend, Nebraska Galen and Jamie Tuttle Gary and Chere Tuttle  
Spohn Farms Friend, Nebraska Scott and Katie Spohn, Keith and Shirley Spohn  
Milton Bros. Trucking Friend, Nebraska Harvey and Sandy Milton, Wayne and Lorri Milton  
Precision Seeds and Chemical Friend, Nebraska Dave and Brenda Brauer, Brandon and Kate Vossler  
Milligan Insurance Agency Milligan, Nebraska Eric and Tara Milton Neil and Tami Filipi  
H.R.W. Farming Friend, Nebraska Harvey Milton, Wayne Milton, Brent Milton, Eric Milton, Bob D. Milton and Logan Milton

## Supporting Cancer Research





Bid to win this  
**1950 FORD CUSTOM**

During one of four  
**LIVE AUCTIONS** at the  
**Cattlemen's Ball**

**June 1-2, 2018**

*Sponsored by*  
**PATRICIA SCHARDT  
& SCHARDT FOUNDATION**



**STIHL**  
OUTDOOR POWER  
1-800-333-5161  
www.superioroutdoorpower.com

**Kawasaki**

**SUPERIOR**  
INDUSTRIES, LLC  
OUTDOOR POWER CENTER

**YAMAHA**

**STIHL**

**YAMAHA**

**Superior**  
INDUSTRIES, LLC  
SPRAYERS

**Kawasaki**

**YAMAHA**

**Superior**  
**OUTDOOR POWER**

1135 E. 3RD ST. • SUPERIOR, NE • (800)-333-5161  
www.superioroutdoorpower.com

**f**

**Cattlemen's Ball**  
**LIVE AUCTION**

This LOADED  
2018 Yamaha  
QuietTech Gas Golf Car  
COULD BE YOURS!



**TITAN**  
TRAILER MFG. INC.



Flatbed Trailers

a **HIGHER** standard of **QUALITY.**

Titan Trailer offers a full line of Horse Trailers, Flatbed Trailers, Utility Trailers, Dump Trailers, Stock Trailers and Custom Trailers.



Stock Trailers



**TITAN** **866-294-4514**

TRAILER MFG. INC.  
www.titantrailer.com

2306 S. Hwy 77, Waterville, KS 66548  
Phone: 866-294-4514 Fax: 785-363-2472  
Email: info@titantrailer.com

IN LOVING MEMORY OF  
*Lillian Dahlkoetter*



WHAT A BLESSING YOU WERE  
TO US AS A MOTHER  
AND A GRANDMOTHER....  
WE MISS YOU EVERY DAY!!

*Karen, Tim, Isaac, Emily and family  
Natalie and family and Andy and family*

**MAKE  
THE MOST  
OF EVERY BITE**



**Pioneer.com/Beef**



**PIONEER**  
ALFA SEED CORN

PIONEER® brand products are provided subject to the terms and conditions of purchase which are part of the labeling and purchase documents.  
©, ®, TM Trademarks and service marks of DuPont, Pioneer or their respective owners. © 2018 PHIL. DUPPF016016VA 18D-1102

Welcome to the  
**Cattlemen's Ball!**



We're taking steps to "Whip Cancer"  
by offering:

- 3D mammography
- Minimally invasive breast biopsies

**Brodstone**  
MEMORIAL HOSPITAL

Superior care close to home.  
Superior, Nebraska

Proud sponsor  
of the  
Rawhide Run

brodstonehospital.org





Every day Nebraska farmers and ranchers are out taking care of their land and animals providing nutritious food for a growing population.

Nebraska Farm Bureau works hard daily at the state capitol to make sure your right to farm and ranch is protected.

**You Belong Here.  
Join today!**



[www.nefb.org](http://www.nefb.org)

**BIC** CASE III AGRICULTURE  
Bruna Implement Company  
Washington, Kansas

785-325-2232



[www.brunaimplementco.com](http://www.brunaimplementco.com)

**Cottlemen's Ball**  
OF NEBRASKA

**WELCOME**

**GOOD2GO**  
CONVENIENCE STORES

**Valentino's**  
Pizza, Pasta & So Much More!  
Carry-out / Serving Breakfast, Lunch & Dinner

402-768-6140  
243 S. 13th St. - Hebron, NE

402-353-2040  
Hwy 81 - Bruning, NE

A Division of  
**Lichti Oil**

Gas • Diesel • Propane • Lubricants  
Shickley, Nebraska  
1-800-848-3778



**MURPHY**  
TRACTOR & EQUIPMENT CO.

Gering (308)436-2177 | Grand Island (308)381-0741 | Lincoln (402)467-1300

North Platte (308)534-7020 | Omaha (402)894-1899 | Sioux City, IA (712)252-2753

[murphytractor.com](http://murphytractor.com)



**Kawasaki**  
***GOOD TIMES™***  
SALES EVENT



**LOW FINANCING**  
*AND* **HUGE FACTORY INCENTIVES**

TAKE ADVANTAGE OF THESE GREAT OFFERS NOW





\*Promotional finance offers are available through 120 Month Term, Synthetic Lease, and Synthetic Finance. Offer valid through 12/31/2012. Visit a Kawasaki dealer near you to register your 501 cc of Motor® with the 501 cc and learn more about the Good Times® sales event. ©2012 Kawasaki Motors Corp., U.S.A. Kawasaki.com

**Kawasaki**

*In Honor of cancer survivors:  
Jane Tonniges, Reiss Bruning,  
Frank and Mary Bruning*



In Loving Memory of Mary's brother,  
Walter E Reiss, MD, 11/27/1933 - 6/24/2012

*Walt spent his life as a family practice doctor in  
California and donated much of his time to  
Salvation Army and as a mission doctor in Mexico.*



**Christensen**  
Cattle & Trucking Inc.

***“Devoted to Beef  
Quality Excellence!!”***

**DBL<sup>INC</sup>**  
**Sandy Ridge Cattle Inc.**

**Years of promoting beef for a healthy  
diet and supporting cancer research !!**

**Dean Christensen**  
(308)550-0298  
Office(308)536-2405

**Brett Zikmund**  
(308)940-0446  
Fullerton, NE

**Bonnie Christensen**  
(308)550-0299  
dbl@hamilton.net



# TITAN

TRAILER MFG. INC.

**TITAN TOUGH!**    A HIGHER STANDARD OF QUALITY



**866-294-4514**

2306 S. Hwy 77, Waterville, KS 66548    [www.TITANTRAILER.com](http://www.TITANTRAILER.com)



With more than 150 years  
of experience, this isn't  
our first rodeo.

Union Pacific is proud to support the  
Cattlemen's Ball of Nebraska.



### New & Used Silencer Chutes

Dubas Equipment LLC  
PO Box 458  
Fullerton, NE 68638

Gene 308-380-2727  
Office 308-536-2369

[geno@dubascattle.com](mailto:geno@dubascattle.com)  
[www.silencerchutes.com](http://www.silencerchutes.com)

### SMARTER INSURANCE FOR AGRICULTURE®

Farm | Ranch | Crop | Commercial Ag

 FARM BUREAU  
FINANCIAL SERVICES



No one knows farming and ranching  
like Farm Bureau.

For more than 75 years, we've been a trusted  
insurance leader providing comprehensive  
coverage for your farm/ranch, your machinery,  
your livestock — and so much more. We're  
proud of our agricultural roots and that  
we're the #1 ag insurer in our territory.

**Nate Casey**  
(402) 768-6218



## KNOBEL SEEDS

*Quality Seed for Every Need*

72055 567<sup>th</sup> Avenue  
Fairbury, NE 68352  
402.446.7394

**Mark & Jan Knobel**

*We are thankful for all the cancer  
research and the dedication of all the  
doctors, nurses and health care  
providers that took care of all of us  
who have faced this journey.*





Visit us for all of your John Deere Needs.  
Sales, Parts, Service and AMS support!

Experience the **LandMark** Difference



745 N. 13th | Hebron | 402-768-6077  
[landmarkimp.com](http://landmarkimp.com)



## 2018 Hotwood's Lil' Sport 510

Aluminum Pontoon Boat with Shoreland'r  
Galvanized Trailer, Canopy and 2 Seats.

**Bid to win this fun little boat!**

Hotwood's is proud to  
be a sponsor of the  
Cattlemen's Ball of  
Nebraska 2018



### Your Local Reinke "Plus Certified" Dealer & Service Center

- Reinke center pivot and swing arm systems
- Extensive parts inventory • Factory-trained technicians
- Underground pipe & electrical installation and repairs
- Replacement cost pivot insurance
- New system financing

# South Central IRRIGATION

Deshler, Ne ☎ (402) 365-7202

5426 Hwy 136 • Deshler, NE | (402) 365-7202



Dick Walsh Agency, Inc.

1248 Lincoln Ave | P.O. Box 189

Hebron, NE 68370

Bus 402-768-6426

Fax 402-768-6977

Proud Sponsors of the Cattlemen's Ball of Nebraska 2018





## BADEN SERVICE INC.

**Your Reinke® System  
Set Up Specialist**



**We are proud to support the 2018  
Cattlemen's Ball of Nebraska**

**Dale Baden**  
Alexandria, NE

[www.metalquest.net](http://www.metalquest.net)



**Precision Machining**  
Oil Field • Hydraulic Components



**METALQUEST**  
*A Quest for Perfection*



**Polansky Seed**  
**(785) 527-2271**  
BELLEVILLE, KS



**ASHLEY SPITSNOGLE'S  
ART**

[www.ashleyspitsnogle.com](http://www.ashleyspitsnogle.com)



**LIVE PAINTING  
to be Auctioned  
+  
3'x4' Giclee Print  
of Scott Frost  
'The Return'**



On the Ranch, in the Feedlot, Farm or CONSTRUCTION Site

## Strobel has an EARTH MOVER for YOU.



Available in General Purpose, Medium Duty,  
Heavy Duty and Extreme Duty (pictured)

"I've had my Strobel Box Scraper for over ten years  
now...the only thing I've done is replace the blades."  
— Joseph, Redding, CA



### BREAKING NEW GROUND — STROBEL STRONG!

Since 1946, Strobel Manufacturing has been building high quality equipment that  
gets the job done — on the construction site, farm, feedlot or ranch. We are  
committed to innovation, responsiveness and problem-solving... that's why  
every piece of Strobel equipment is built — Strobel Strong.

308.548.2254 • sales@strobelmfg.com  
strobelmfg.com

GO TO [WWW.STROBELEARTHMOVING.COM](http://WWW.STROBELEARTHMOVING.COM)  
FOR VIDEOS



## Welcome to the 2018 Cattlemen's Ball

# Quensing Trucking



Byron, Nebraska  
Trey 402-460-7620  
Tobe 402-460-6626



B

No matter what segment of the industry you are in,

### WE BELIEVE

the end-goal is the same: the highest quality beef that  
yields premiums. By focusing on maternal without  
undermining terminal traits, we offer the genetics  
for just that, so as an industry we can progressively

# BREED BETTER BEEF

### BRUNING FARMS

BRUNING, NEBRASKA

JOIN US FOR OUR ANNUAL PRODUCTION SALE  
SUNDAY, FEBRUARY 17, 2019  
[BRUNINGFARMS.COM](http://BRUNINGFARMS.COM) • REISS 402-768-3332



U.S. PREMIUM  
BEEF  
Qualified Seedstock Supplier



## CERTIFIED PIEDMONTESE®



## Lean & Tender Gourmet Beef

No Hormones No Antibiotics No Steroids

[www.piedmontese.com](http://www.piedmontese.com)





## Hebron Churches Welcome You

### Saturday Evening:

Sacred Heart Catholic Church  
(436 N 3rd) 6:00 pm

Grace Lutheran Church  
(224 N 4th) 6:30 pm

### Sunday Morning:

Harvestime New Life Assembly  
(1202 Union Ave) 10:00 am

Hebron Bible Church  
(145 S 4th) 10:00 am

Sacred Heart Catholic Church  
(436 N 3rd) 10:00 am

United Methodist Church  
(701 Lincoln Ave) 9:00 am

Faith Lutheran Church  
(420 Charles Road) 8:00 am

First Community Church  
(224 N 5th) 10:00 am

First Presbyterian Church  
(140 N 5th) 10:30 am

Grace Lutheran Church  
(224 N 4th) 9:00 am

### Sunday Afternoon Mass:

Sacred Heart Catholic Church (436 N 3rd) 4:00 pm

## COUNT ON THE FUEL THAT NEVER FAILS

If you need a smart fuel for your irrigation engine, grain dryer, flakers, dairy, dairy processing, poultry farm, shop or home, choose natural gas.

It's a reliable, cost-effective solution made right here in our country.

For details, call **800-999-5694**, or visit **NaturalGetsItDone.com/ag**.



**SHICKLEY, NE**  
**1-888-627-WELL**

**Proud Supporters of  
the 2018  
Cattlemen's Ball of  
Nebraska**

## THANK YOU for Feeding Our VOLUNTEERS!

Valentino's  
4 A Cure 2017 CBN  
Thayer County Feeders  
Omaha Steaks  
Farm Credit Services  
RW's Dining & Drinks  
Subway  
Schwan's Ice Cream  
Rotella's Bakery

Many thanks to our Volunteer Food Committee Chairmen,  
**Kurtis & Susie Elting**

Volunteer Support sponsored by Mike & Ellen Long



**outdoortire.com™**  
WORK PLAY RIDE



**MORE TIRES. GREAT PRICES.  
THAT'S HOW WE DO BUSINESS.**

Outdoortire.com provides nation-wide sales  
and delivery of "off road" tires and wheels.

- FLAT PROOFING SOLUTIONS
- AGRICULTURE FARM TIRES
- ATV/RTV
- COMMERCIAL TRUCK TIRES
- CONSTRUCTION TIRES
- LAWN & GARDEN
- IRRIGATION TIRES & WHEELS
- ST TRAILER TIRES

1-844-239-7842

OMAHA, NE

[www.outdoortire.com](http://www.outdoortire.com)



# ONLINE AUCTIONS

End Every Wednesday on

## AuctionTime.com®

Powered by TractorHouse.com, MachineryTrader.com, TruckPaper.com & MarketBook.com

**Including....**



**Farm  
Equipment**



**Construction  
Equipment**



**Trucks**



**Trailers**



**Attachments**



**NO HIDDEN RESERVES**

Register to bid today for Free! (800) 334-7443

Since 1890

# THE LIVESTOCK BRAND



Proud Supporter of  
the Cattlemen's Ball of  
Nebraska, Inc. and their  
drive to fight cancer.

**Wilson  
TRAILER**

Since 1890... A Good Name to Have Behind You!

Sioux City, IA  
800-798-2002

Grand Island, NE  
800-381-1802



# WRANGLER PORTABLE CORRALS

Catching, sorting, loading and working cattle  
all with one system has never been easier!

Linn Post & Pipe's Wrangler Portable corral  
system can do just that.

**LINN**  
POST & PIPE, INC.



For more pictures and video,  
scan the code!

800.526.0993 Linn, KS | 800.638.4036 Creighton, NE

[www.linnpost.com](http://www.linnpost.com)



## This image shows a full page of blank, cream-colored paper with horizontal blue or grey ruling lines. The lines are evenly spaced and run across the width of the page. There is no handwriting or other markings on the paper.







Tyson

FRESH MEATS TEAM

the beef  
& pork  
experts™



# BE THE DIFFERENCE

**Reinke is proud to be a supporter  
of cancer research, working to**



[www.reinke.com](http://www.reinke.com)

